

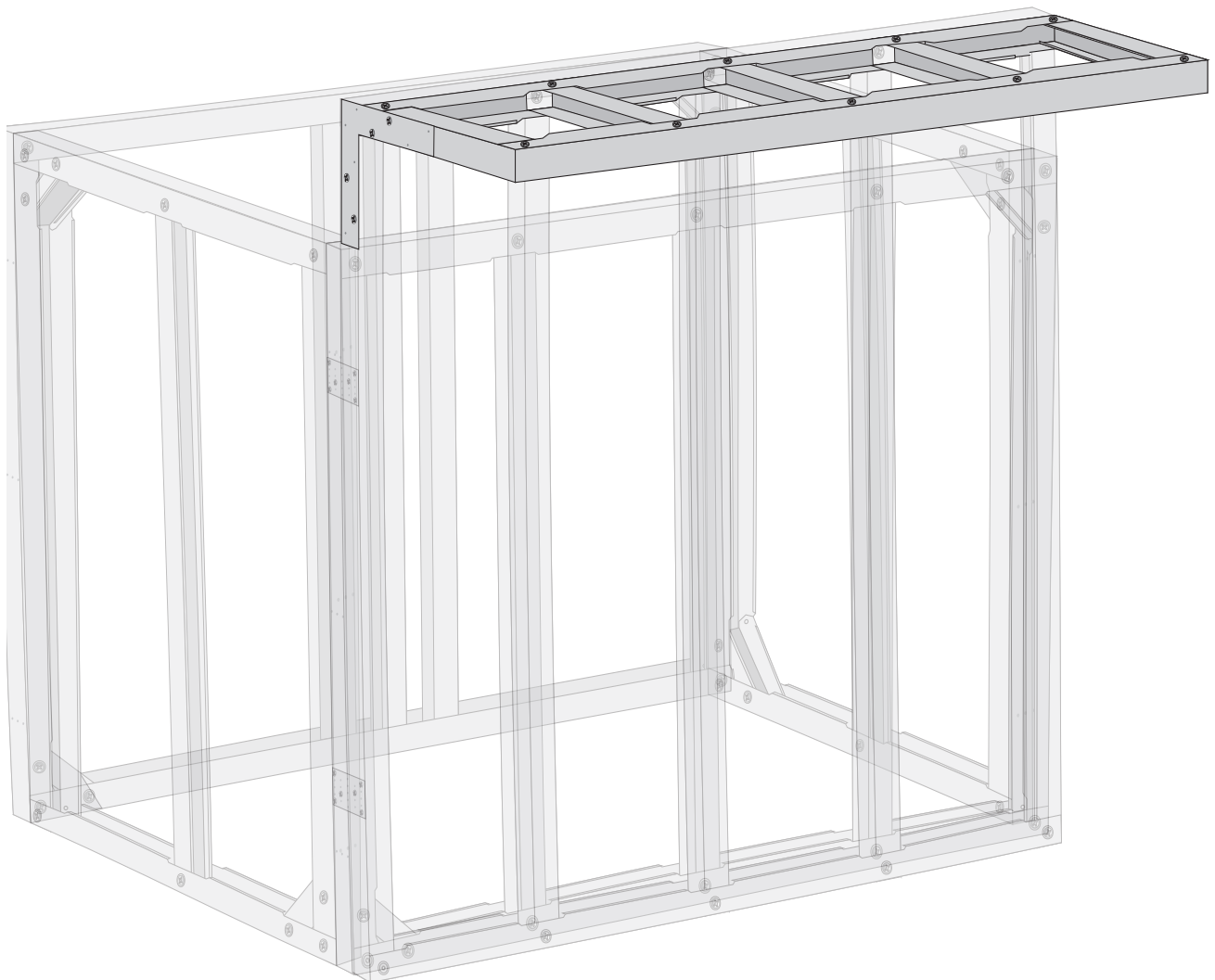

*Easy-to-Follow*

# INSTRUCTION *Manual*

## 4-FOOT OVERHANG ASSEMBLY



## COPYRIGHT NOTICE

This instruction manual is protected under Copyright Law of the United States of America.

This copy of the instruction manual is for the sole use of the original purchaser. A license to use the information contained herein is granted to the original purchaser by the author.

No part of this instruction manual, including but not limited to, photographs, pictures, diagrams, or illustrations may be reproduced, copied or transferred in print or electronically to third parties without the express written permission of the author. Any copying, retransmission, editing or distribution without the express written permission of the author will terminate the license and all copies in the possession or distribution by the purchaser will be considered unlicensed and therefore in infringement of U.S. Copyright Law.

Furthermore, if the purchaser wishes to use the information contained herein for the creation or supplement of business, whereby BBQ islands would be part of the business, then the purchaser is not permitted to use or distribute any of the enclosed information within that business without the express written permission of the author.

## WARNINGS

When working with metal, the edges are very sharp and may have small splinters across the edges. Be extremely careful when handling each piece. It is highly recommended to wear safety glasses and gloves at all times while building your modules. Eye protection is required when cutting or screwing metal pieces to protect against errant metal pieces and particles.

Keep children and animals away from the metal pieces and completed frame kits.

Please follow all manufacturer directions on how to properly install BBQ products.

Check with your local codes on construction for the required permits you may need for construction of your BBQ island.

Utility lines should only be installed by a licensed plumber or electrician per the code in your area. Do not forget to get a permit if required by local laws or regulations.

Please read all directions on how to install your DIYBBQ island modules. Installation of the product is at your own risk; DIYBBQ, LLC is not liable for misuse of the module frame kits nor for damage to any of your BBQ products.

## NOTICE OF LIMITED LIABILITY

**NOTICE:** DIYBBQ, LLC shall **NOT** be liable for incidental and consequential damages, directly or indirectly sustained to any person(s), equipment, tools, or appliances during or after the installation of any BBQ island, related directly or indirectly to the installation and operation of any BBQ island or appliances, nor for any loss caused by application of these goods not in accordance with current printed instructions or for other than the intended use. DIYBBQ, LLC's liability is expressly limited to replacement of defensive goods. Any claim shall be deemed waived unless made in writing to DIYBBQ, LLC at 26520 ADAMS AVE., MURRIETA, CA 92562 within thirty (30) days from the date it was or reasonably should have been discovered.

## ARBITRATION AGREEMENT

USE OF OR PURCHASE OF ANY DIYBBQ, LLC PRODUCTS, OR ANY GOODS AVAILABLE FOR PURCHASE THROUGH DIYBBQ.COM REQUIRES THAT ALL CLAIMS BE SETTLED UNDER THIS BINDING ARBITRATION PROVISION, WHICH AFFECTS YOUR LEGAL RIGHTS AND MAY BE ENFORCED BY EITHER PARTY.

In the event a dispute shall arise between DIYBBQ, LLC and any purchaser of any DIYBBQ, LLC product or good available through diybbq.com, it is hereby agreed that the dispute shall be referred to a USA&M office to be designated by USA&M National Headquarters for Arbitration in accordance with the applicable United States Arbitration and Mediation Rules of Arbitration. **The arbitrator's decision shall be final and legally binding, and judgment may be entered therein.**

Each party shall be responsible for its share of the arbitration fees in accordance with the applicable Rules of Arbitration. In the event a party fails to proceed with arbitration, unsuccessfully challenges the arbitrator's award or fails to comply with the arbitrator's award, the other party opposing party is entitled to costs of suit, including a reasonable attorney's fee for having to compel arbitration or defend or enforce the award.

If you are still having trouble putting your module together, we are here to help. Contact us at 800-289-3492 or email [support@diybbq.com](mailto:support@diybbq.com).

# Required Tools for Assembly

Vise Clamps

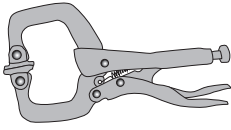

Cordless Drill



Carpenter Square

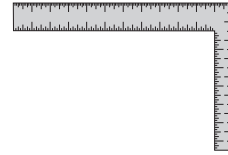

Magnetic Level



Aviation Snips

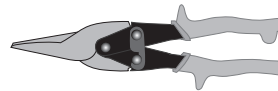

## PROFESSIONAL TIPS

### Proper Safety equipment is extremely important.

Always wear safety glasses and gloves when assembling your modules.

Using proper tools will make the project much easier to do and will help you obtain a properly built project. This list is of the basic tools you'll need to build your modules. You may use whatever tools you deem necessary to complete your project in the easiest way possible. All tools listed here and others you may wish to acquire can be found at Lowes®, Home Depot®, Amazon and other on-line retailers.

A cordless impact driver will make steel frame assembly easier and help protect the edges of the HardieBacker® cement board from cracking during installation onto the frame.

## Useful Terms

**Unassembled Module:** A complete module set that must be completed from the ground-up.

**Perimeter Walls:** The front and back walls of a module.

**Cross Channels:** The side walls of a module that connect to the Perimeter walls.

**Track:** The top and bottom pieces of a Perimeter or Cross Channel wall.

**Stud:** The sides and inside pieces of a Perimeter or Cross Channel wall.

**Angle Brace:** A piece that supports the tracks to the outer studs of the front and back walls of an unassembled module.

**L-Bracket Plate:** A larger union plate in the shape of an L. (Sold Separately)

**Dimple:** The indentation around a precut hole within a track or a stud.

**Web Holes:** The small, precut holes, usually appearing in sets of three on the back side of a Cross Channel wall that act as a guide for drilling when attaching Cross Channel walls to the front and back walls of a module.

**Assuage:** The small creases that appear on the ends of a stud that allows for easier assembly (see image to right).

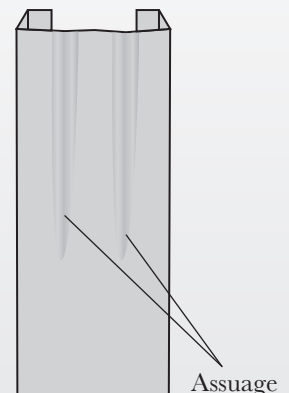

# What's in the box?

Tracks

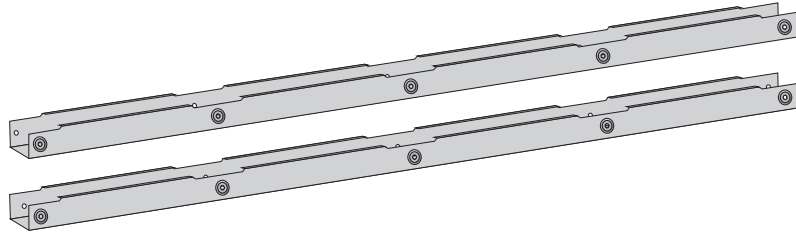

Studs

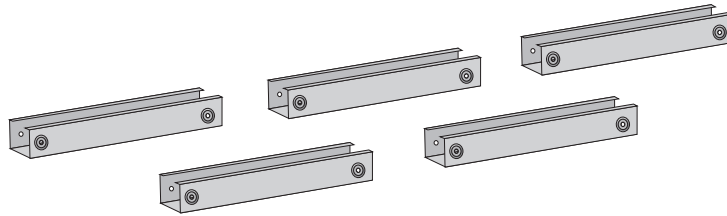

Self-Tapping Screws

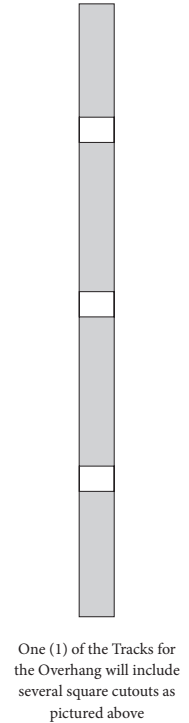

One (1) of the Tracks for the Overhang will include several square cutouts as pictured above

## CHECK LIST

- ☐ 2 Tracks (One track includes square cutouts along the edge of the back side; see image above)
- ☐ 5 Studs
- ☐ 20 Self-Tapping Screws

## STEP 1

Align the tracks so that all cuts are aligned properly.  
**Note:** When aligned correctly, the text printed on each stud will read exactly the same.

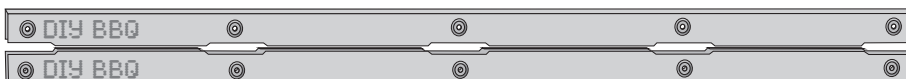

## PROFESSIONAL TIP - ALIGNING CUTS

When aligning the tracks for the back of the module, if the center cuts of each track are misaligned, one of the tracks needs to be flipped so that the center cuts of both tracks line up.

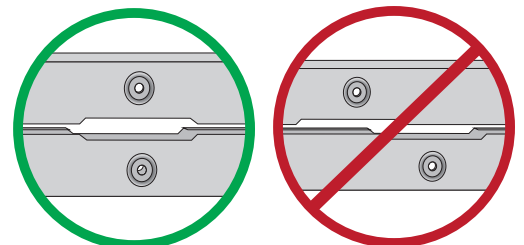

## STEP 2

Spread out the pieces to form a loose framework of the wall prior to attaching anything.

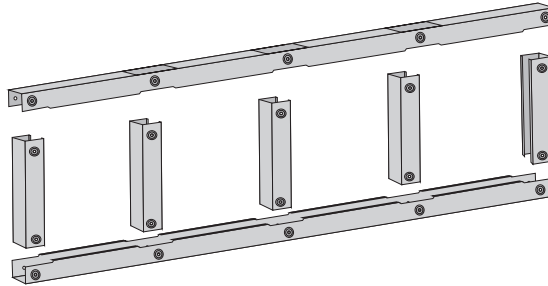

## STEP 3

Slide each stud into the bottom track. Make sure that each of the precut holes match up.

**Note:** Each stud has a number reference, where Stud 1 will sit on the right with each number running consecutively to the left. This isn't necessary, but keeps everything organized.

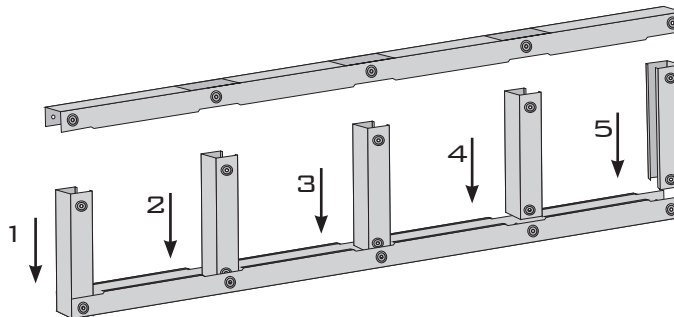

## STEP 4

Slide the top track down and adjust the top of each stud so that they fit comfortably inside the top track.

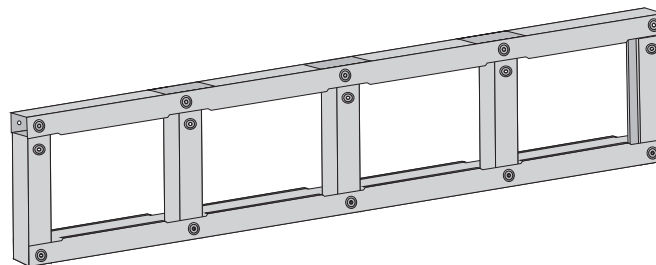

## STEP 5

Use the butt of your palm to carefully but firmly hit each stud into the top track so that all precut holes in both the track and studs are aligned.

**Note:** If the studs do not slip right in when hit, readjust the studs and reapply pressure to the track.

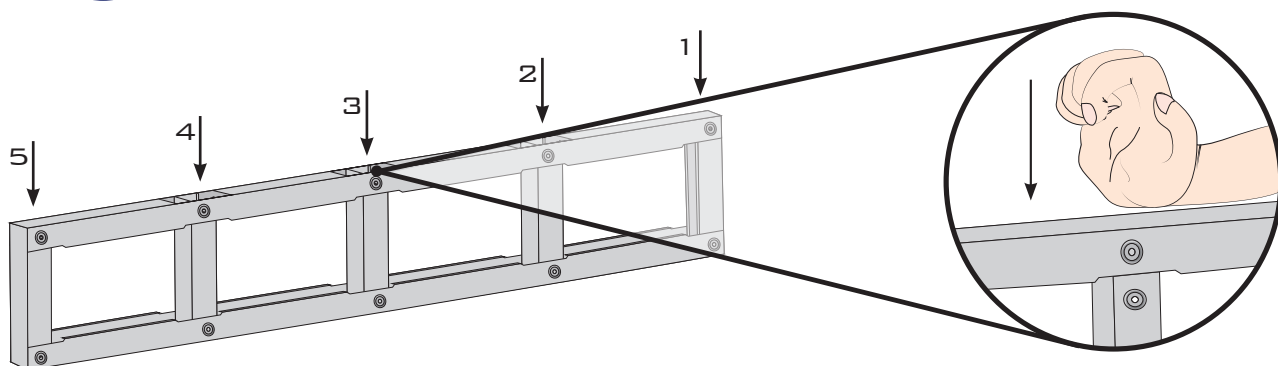

# STEP 6

Drill screws in all pre-drilled holes. When complete, flip the wall over and drill additional screws into the opposite side. You should now have a completed Overhang.

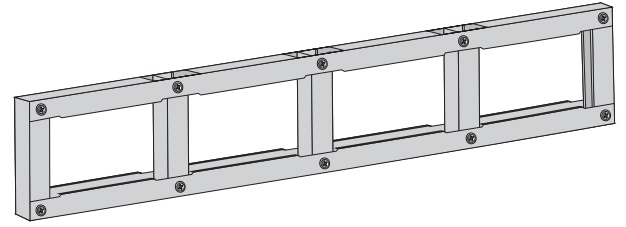
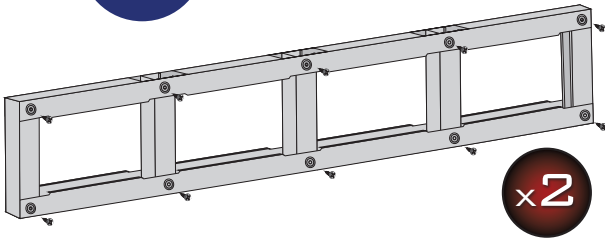

## PROFESSIONAL TIP - FLUSH CORNERS

When placing two corners together, the pieces may not always appear completely flush. This is okay. The integrity of the module will not be affected.

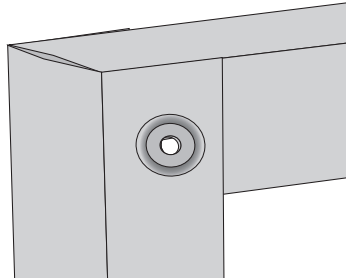

## PROFESSIONAL TIP - UNEVEN HOLES

The pre-drilled holes in two pieces may not always align perfectly. If this is the case, simply angle the screw into the opening of both holes and then twist up while drilling.

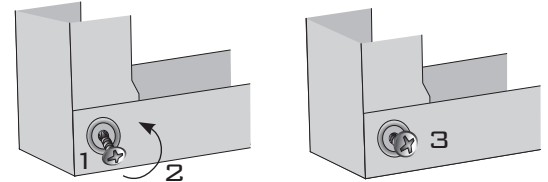

## READ BEFORE PRECEDING TO STEP 7

To attach your overhang to your module, you will need to have your Backsplash assembled (which may already be attached to your main module unit). If you do not have your Backsplash assembled, please review the instructions here: <https://diybbq.com/content/DIYBBQ 4-Foot Backsplash Instruction Manual .pdf>

# STEP 7

Locate your assembled Backsplash and attach one of the L-Brackets to each of the inner studs by 1) slipping the cut of the L-Brackets up through the top of the Track; and then 2) using at least two (2) screws to attach each one.

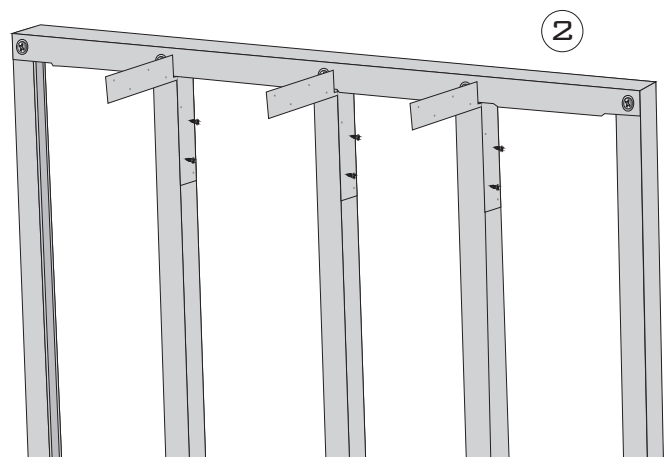
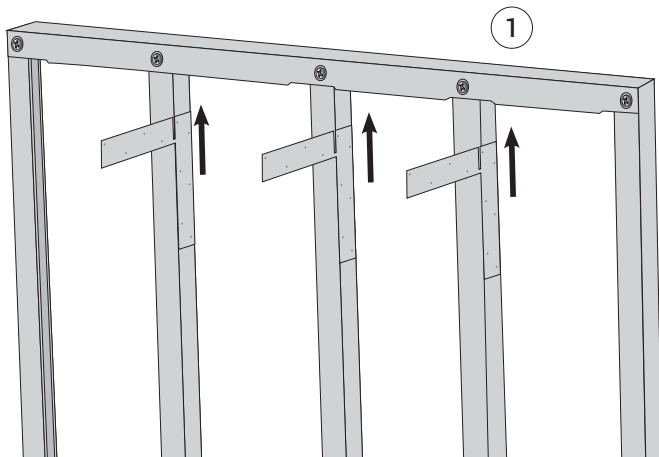

## STEP 8

Slide Overhang onto the Backsplash by allowing the L-Brackets to slide through the precut square holes in the top of the Overhang (see Inset). Make sure that the smooth side of the inner studs and the smooth side of the Backsplash are aligned on the same side.

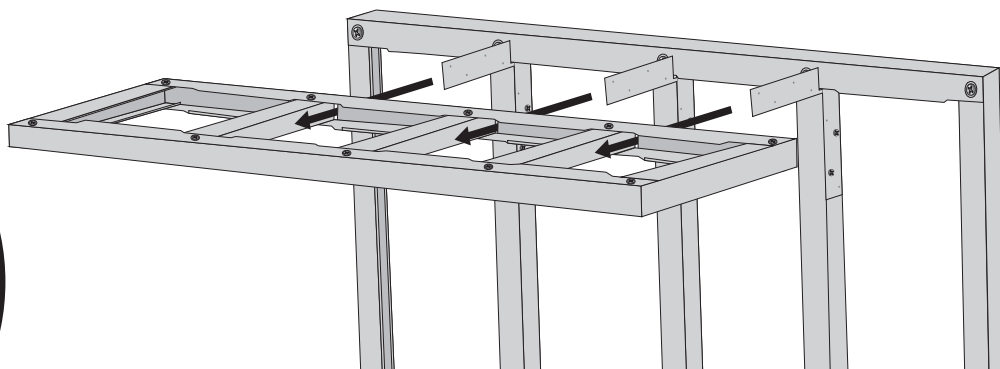
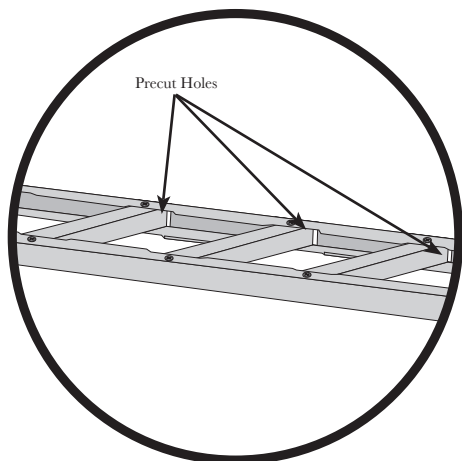

## STEP 9

Attach the L-Brackets to the Overhang studs with at least two (2) screws for each L-Bracket (for a total of six (6) screws).

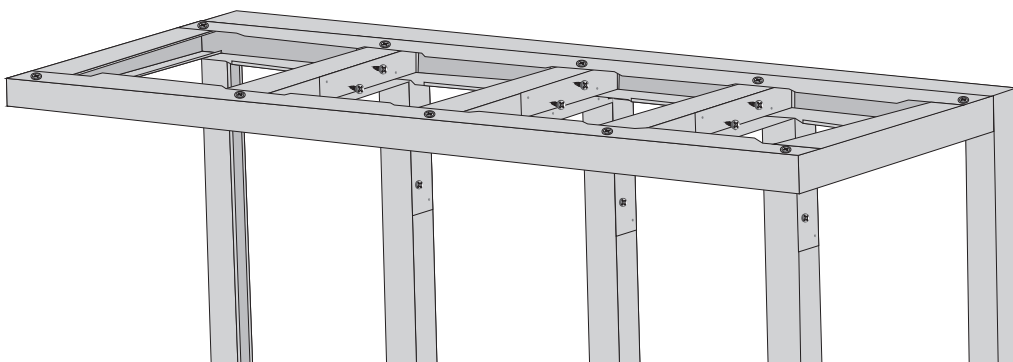

## STEP 10

Attach an additional L-Bracket to the outside of the Overhang on each side of the module. Use at least four (4) screws in each L-Bracket (for a total of eight (8) screws) to provide a strong attachment. (Any amount from four to 10 screws on each may be used.)

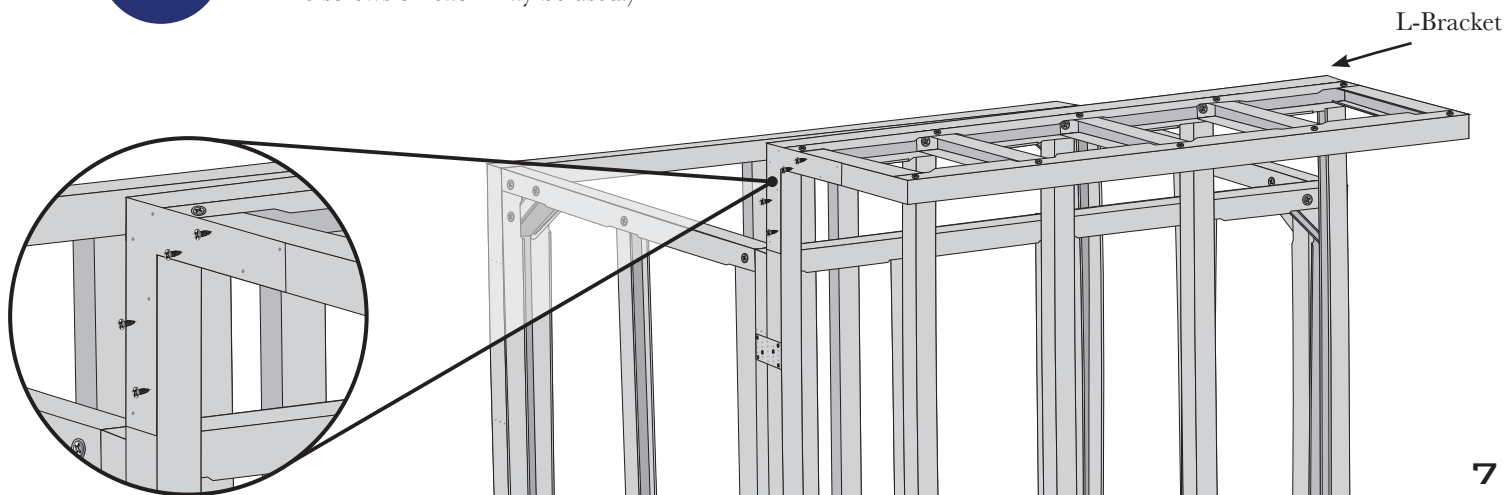

# STEP 1

You should now have a completed 4-foot Overhang.

