



*Easy-to-Follow*

# INSTRUCTION *Manual*

3-FOOT MODULE ASSEMBLY

## COPYRIGHT NOTICE

This instruction manual is protected under Copyright Law of the United States of America.

This copy of the instruction manual is for the sole use of the original purchaser. A license to use the information contained herein is granted to the original purchaser by the author.

No part of this instruction manual, including but not limited to, photographs, pictures, diagrams, or illustrations may be reproduced, copied or transferred in print or electronically to third parties without the express written permission of the author. Any copying, retransmission, editing or distribution without the express written permission of the author will terminate the license and all copies in the possession or distribution by the purchaser will be considered unlicensed and therefore in infringement of U.S. Copyright Law.

Furthermore, if the purchaser wishes to use the information contained herein for the creation or supplement of business, whereby BBQ islands would be part of the business, then the purchaser is not permitted to use or distribute any of the enclosed information within that business without the express written permission of the author.

## WARNINGS

When working with metal, the edges are very sharp and may have small splinters across the edges. Be extremely careful when handling each piece. It is highly recommended to wear safety glasses and gloves at all times while building your modules. Eye protection is required when cutting or screwing metal pieces to protect against errant metal pieces and particles.

Keep children and animals away from the metal pieces and completed frame kits.

Please follow all manufacturer directions on how to properly install BBQ products.

Check with your local codes on construction for the required permits you may need for construction of your BBQ island.

Utility lines should only be installed by a licensed plumber or electrician per the code in your area. Do not forget to get a permit if required by local laws or regulations.

Please read all directions on how to install your DIYBBQ island modules. Installation of the product is at your own risk; DIYBBQ, LLC is not liable for misuse of the module frame kits nor for damage to any of your BBQ products.

## NOTICE OF LIMITED LIABILITY

**NOTICE:** DIYBBQ, LLC shall **NOT** be liable for incidental and consequential damages, directly or indirectly sustained to any person(s), equipment, tools, or appliances during or after the installation of any BBQ island, related directly or indirectly to the installation and operation of any BBQ island or appliances, nor for any loss caused by application of these goods not in accordance with current printed instructions or for other than the intended use. DIYBBQ, LLC's liability is expressly limited to replacement of defensive goods. Any claim shall be deemed waived unless made in writing to DIYBBQ, LLC at 26520 ADAMS AVE., MURRIETA, CA 92562 within thirty (30) days from the date it was or reasonably should have been discovered.

## ARBITRATION AGREEMENT

USE OF OR PURCHASE OF ANY DIYBBQ, LLC PRODUCTS, OR ANY GOODS AVAILABLE FOR PURCHASE THROUGH DIYBBQ.COM REQUIRES THAT ALL CLAIMS BE SETTLED UNDER THIS BINDING ARBITRATION PROVISION, WHICH AFFECTS YOUR LEGAL RIGHTS AND MAY BE ENFORCED BY EITHER PARTY.

In the event a dispute shall arise between DIYBBQ, LLC and any purchaser of any DIYBBQ, LLC product or good available through diybbq.com, it is hereby agreed that the dispute shall be referred to a USA&M office to be designated by USA&M National Headquarters for Arbitration in accordance with the applicable United States Arbitration and Mediation Rules of Arbitration. **The arbitrator's decision shall be final and legally binding, and judgment may be entered therein.**

Each party shall be responsible for its share of the arbitration fees in accordance with the applicable Rules of Arbitration. In the event a party fails to proceed with arbitration, unsuccessfully challenges the arbitrator's award or fails to comply with the arbitrator's award, the other party opposing party is entitled to costs of suit, including a reasonable attorney's fee for having to compel arbitration or defend or enforce the award.

If you are still having trouble putting your module together, we are here to help. Contact us at 800-289-3492 or email [support@diybbq.com](mailto:support@diybbq.com).

# Contents

4

Required Tools

5

Unassembled 3-foot Module Assembly

21

Quick Panel 3-foot Module Assembly

26

3-foot Backsplash Assembly

31

3-foot Overhang Assembly

## Useful Terms

**Unassembled Module:** A complete module set that must be completed from the ground-up.

**Assembled Module:** A complete module set in which all of the Perimeter walls and Cross Channel walls are pre-assembled prior to shipping.

**Perimeter Walls:** The front and back walls of a module.

**Cross Channels:** The side walls of a module that connect to the Perimeter walls.

**Track:** The top and bottom pieces of a Perimeter or Cross Channel wall.

**Stud:** The sides and inside pieces of a Perimeter or Cross Channel wall.

**Angle Brace:** A piece that supports the tracks to the outer studs of the front and back walls of an unassembled module.

**Quick Panels:** The back and front walls of an Assembled Module that include a second support stud on each end for extra durability.

**Union Plate:** A flat rectangle with pre-drilled holes to help assemble or add extra durability to module walls, cutouts and extra wall accessories. (Sold Separately)

**L-Bracket Plate:** A larger union plate in the shape of an L. (Sold Separately)

**Dimple:** The indentation around a precut hole within a track or a stud.

**Web Holes:** The small, precut holes, usually appearing in sets of three on the back side of a Cross Channel wall that act as a guide for drilling when attaching Cross Channel walls to the front and back walls of a module.

**Assuage:** The small creases that appear on the ends of a stud that allows for easier assembly (see image to right).

**Catch Track:** An additional stud that runs perpendicular to Perimeter and Cross Channel walls within the center of a module. (Used in specialty and cutout modules.)

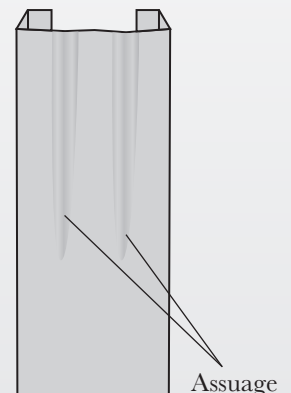

## Required Tools for Assembly

Vise Clamps

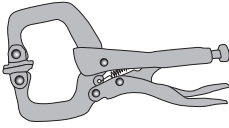

Spring Clamps



Aviation Snips

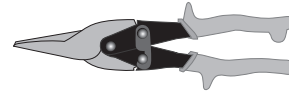

Cordless Drill



Carpenter Square

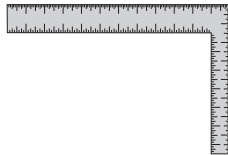

Rafter Square

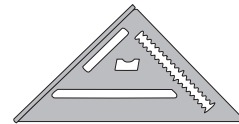

Tape Measure

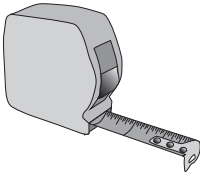

Magnetic Level



Marker



### PROFESSIONAL TIPS

#### **Proper Safety equipment is extremely important.**

Always wear safety glasses and gloves when assembling your modules.

Using proper tools will make the project much easier to do and will help you obtain a properly built project. This list is of the basic tools you'll need to build your modules. You may use whatever tools you deem necessary to complete your project in the easiest way possible. All tools listed here and others you may wish to acquire can be found at Lowes®, Home Depot®, Amazon and other on-line retailers.

A cordless impact driver will make steel frame assembly easier and help protect the edges of the HardieBacker® cement board from cracking during installation onto the frame.

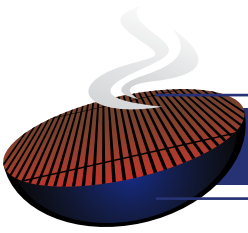

## UNASSEMBLED 3-FOOT MODULE ASSEMBLY

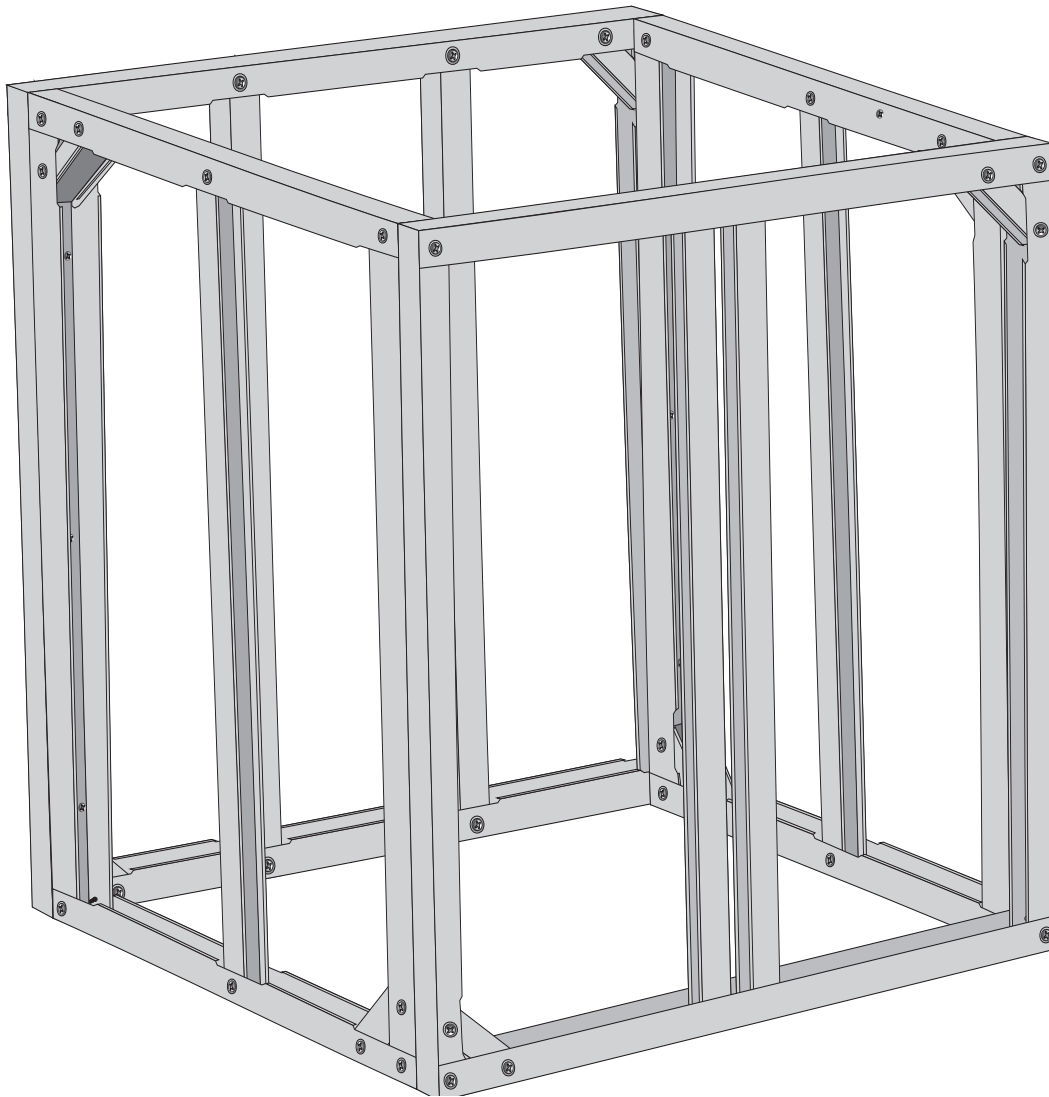

# What's in the box

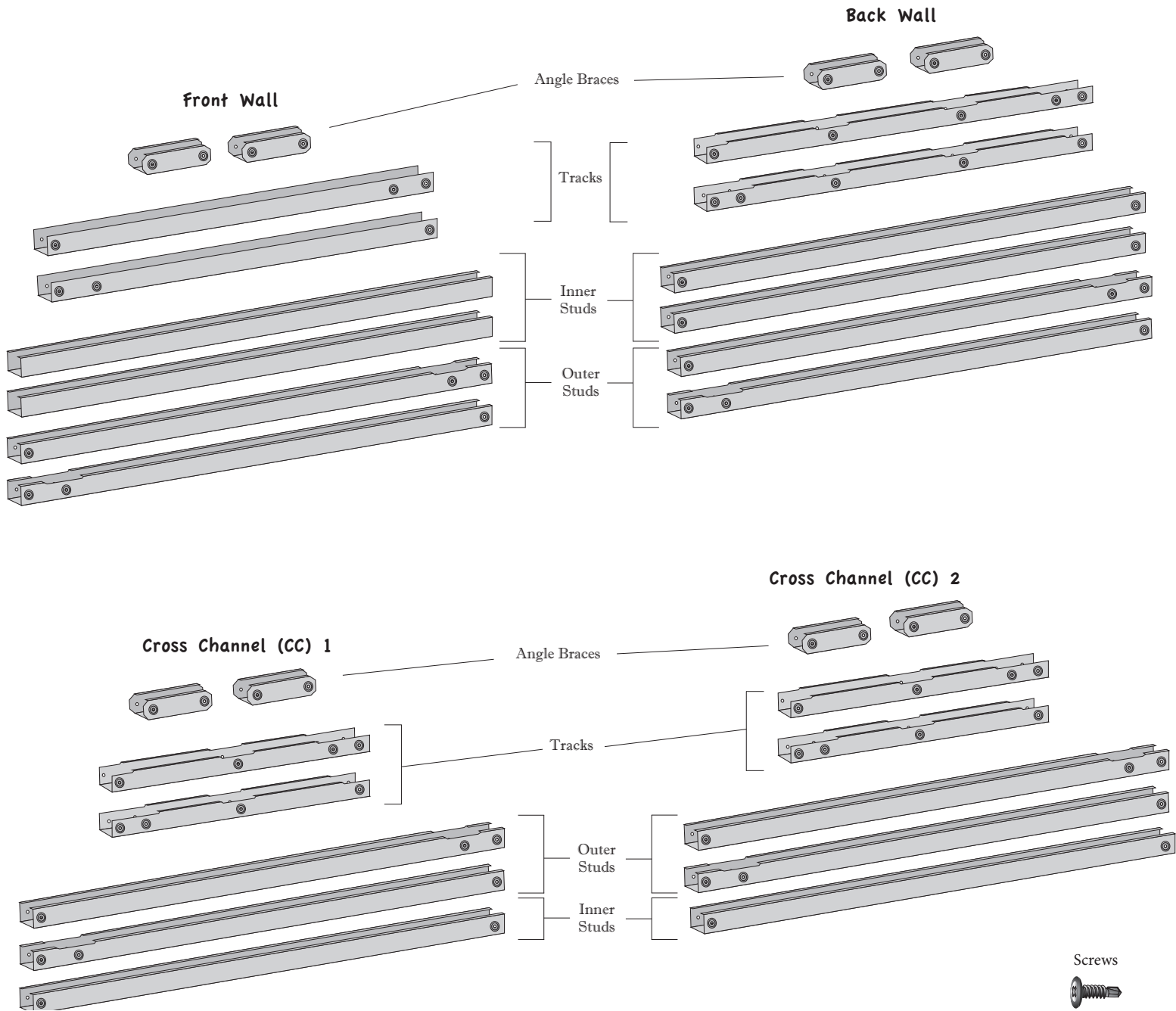

## CHECK LIST

- ☐ 8 Angle Braces
- ☐ 8 Tracks (The tracks for the front wall do not include lips or slats for better maneuverability of studs and for easier cutout insertion.)
- ☐ 8 Outer Studs
- ☐ 6 Inner Studs (The inner studs for the front wall do not include any pre-drilled holes because they are adjustable, allowing for a universal fit of all cutouts.)
- ☐ 100 Self-Tapping Screws

## STEP 1

Align the tracks so that the double dimpled holes are opposite one another.

**Note:** When aligned correctly, the text printed on each stud will read exactly the same.



## STEP 2

Spread out the pieces to form a loose framework of the wall prior to attaching anything.

**Note:** Keep the inner studs off to the side. These will be placed later in accordance with the placement of your cutout module(s).

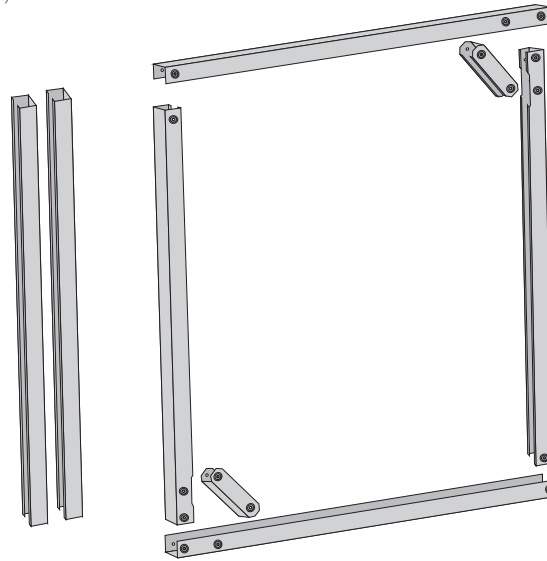

## STEP 3

Place one end of the first angle brace into the bottom track.

**Note:** You may place the angle brace into either the stud or the track first, however, it's easier to maneuver the brace into the opposite piece if you first slide your angle brace into the smaller of the two pieces.

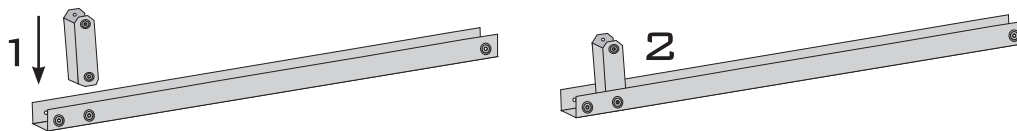

### PROFESSIONAL TIP - PLACING THE ANGLE BRACE

Avoid pinching your fingers in between the angle brace and the stud or track by holding the angle brace at the top most half (as opposed to the bottom most half).

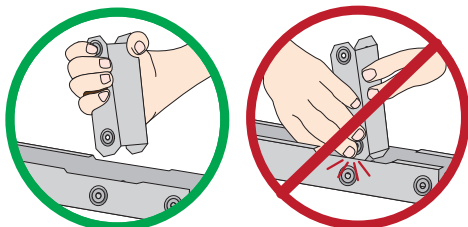

Place the angle brace with the inside facing the center of the stud or track. When placed the opposite way, a gap will form and the angle brace will no longer be flush.

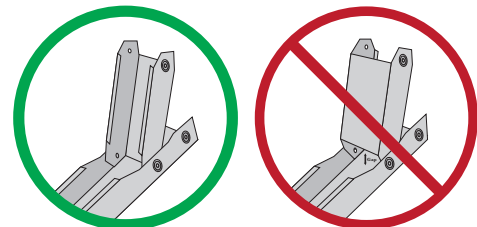

# STEP 4

Slide the other side of the angle brace into the corresponding outer left stud and then easily swing the track into place on the edge of the stud. Reconfigure the pieces so that the track rests at the bottom.

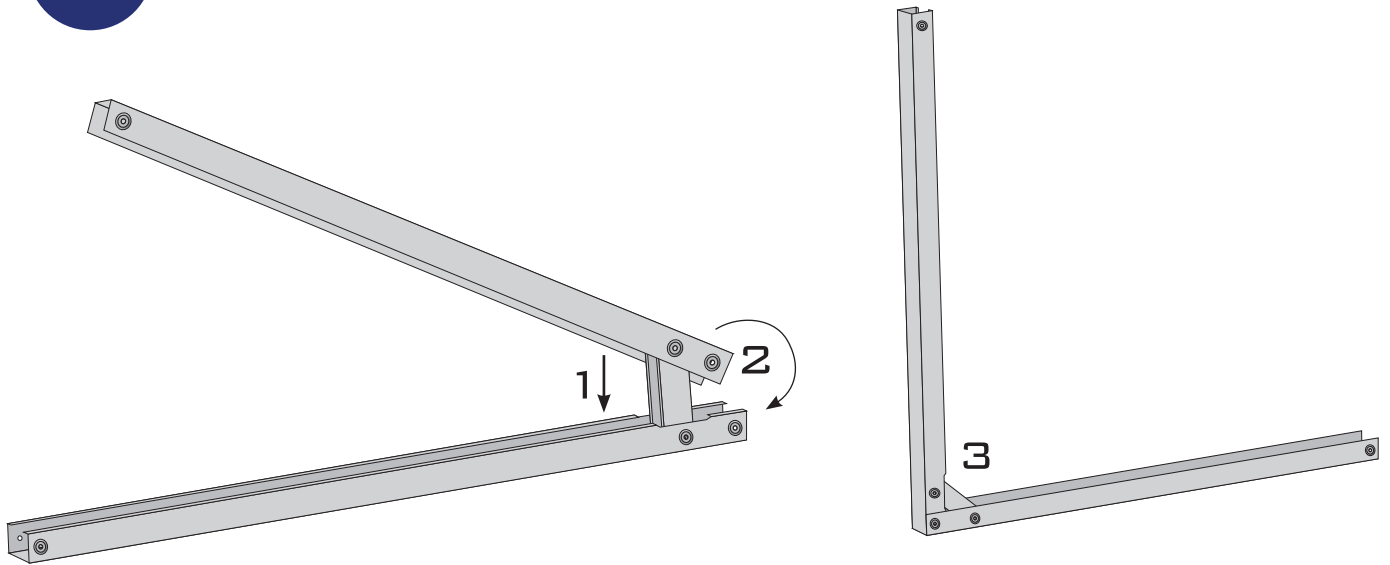

# STEP 5

Repeat steps 3 and 4 to attach the second angle brace to the opposite stud and track. You should now have two L-shaped pieces. Slide the unattached ends together and make sure that all corners are flush.

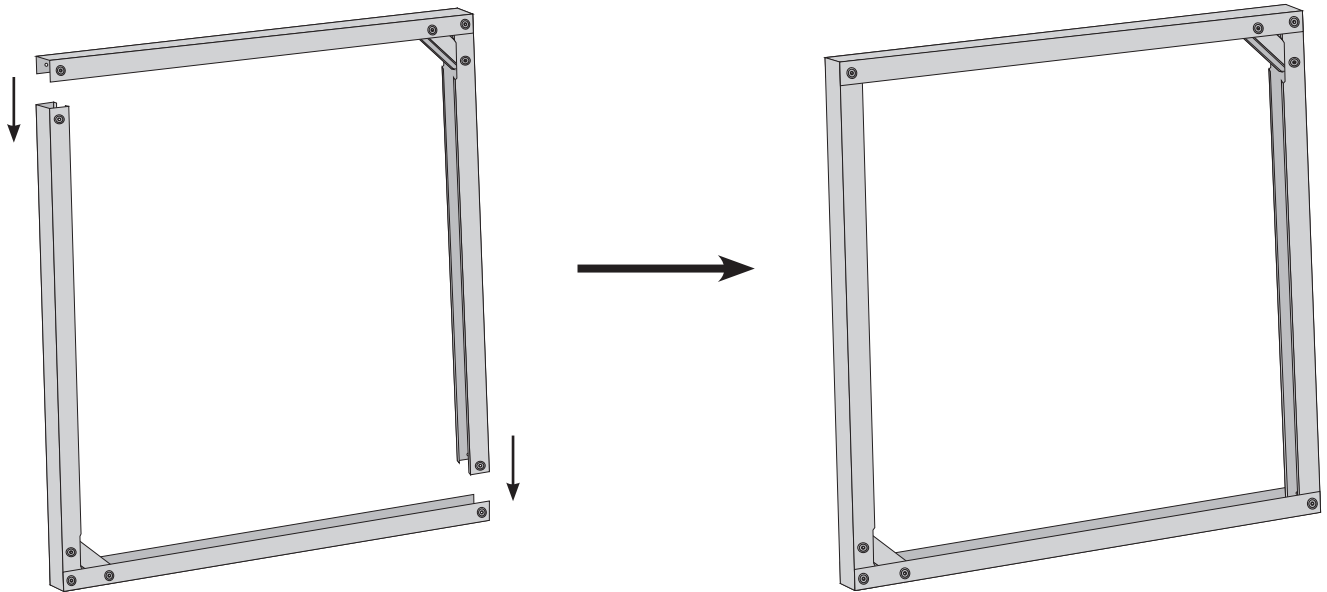

## PROFESSIONAL TIP - FLUSH CORNERS

When placing two corners together, the pieces may not always appear completely flush. This is okay. The integrity of the module will not be affected.

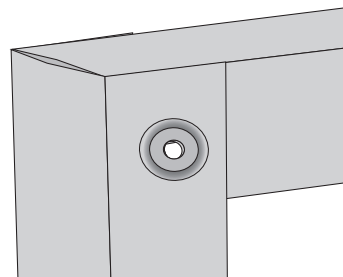



# STEP 6

Drill screws in all eight (8) pre-drilled holes.

**Note:** Begin with the Corner (see Inset), then finish screwing the angle brace before moving counterclockwise around the frame.

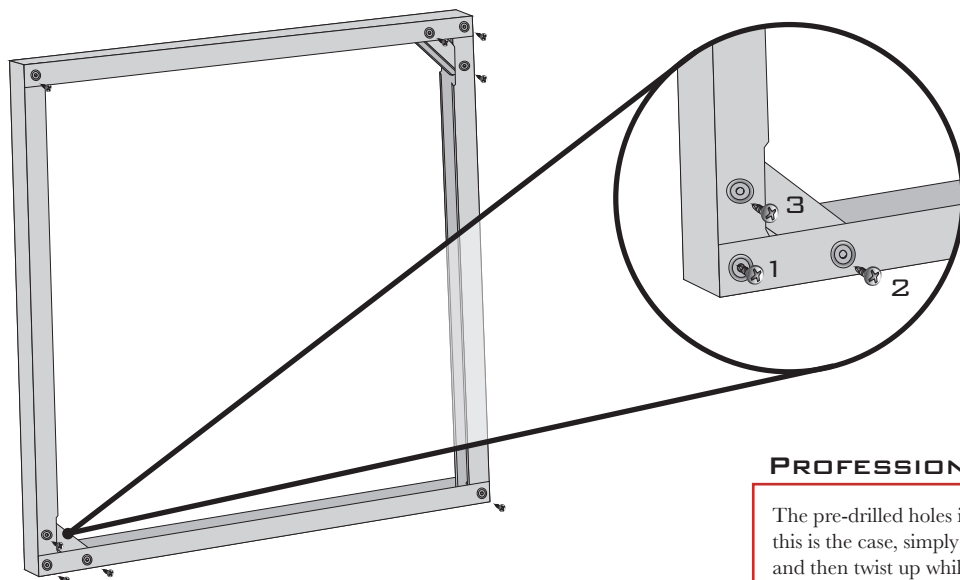

## PROFESSIONAL TIP - UNEVEN HOLES

The pre-drilled holes in two pieces may not always align perfectly. If this is the case, simply angle the screw into the opening of both holes and then twist up while drilling.

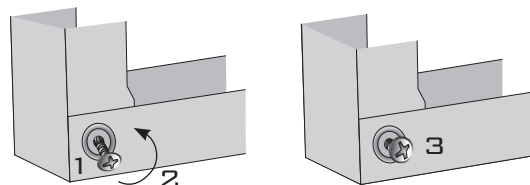

# STEP 7

Flip the frame over and repeat step 6 on the opposite side. You should now have a completed frame wall with a set of separate studs that will be added and adjusted once the entire module has been completed.

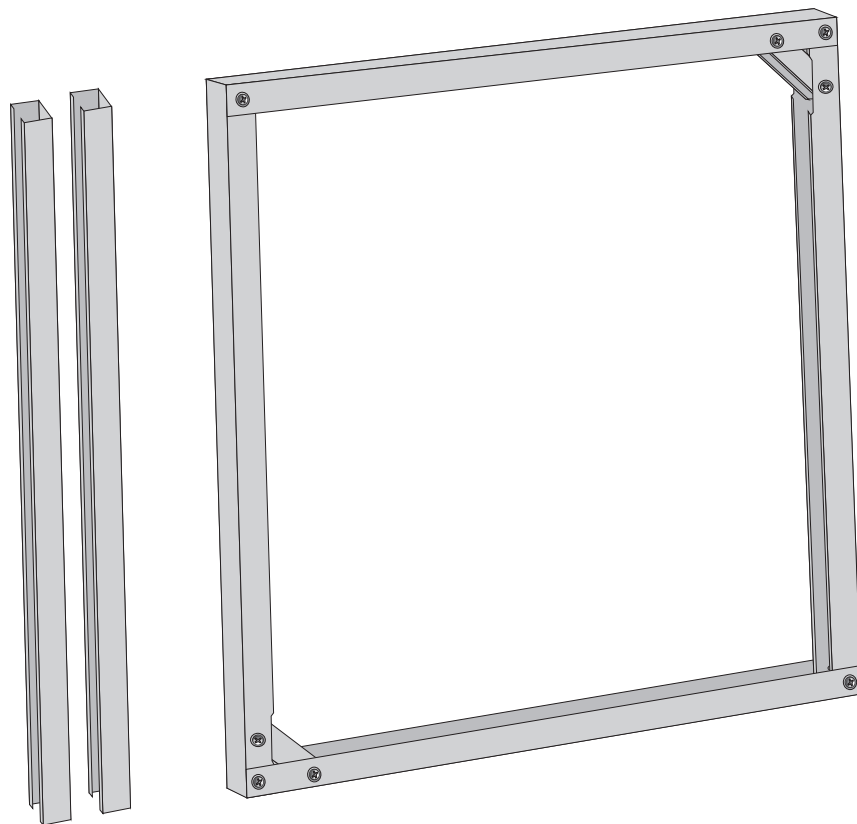

## Back Wall Assembly

### STEP 1

Align the tracks so that the double dimpled holes are opposite one another.

**Note:** When aligned correctly, the text printed on each stud will read exactly the same.

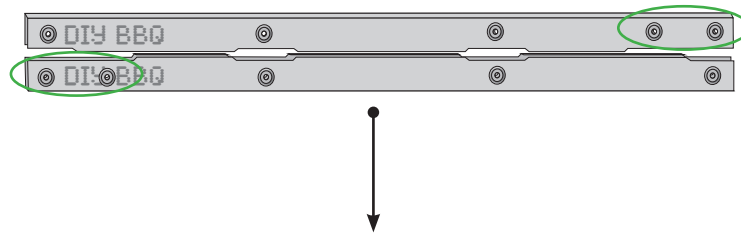

#### PROFESSIONAL TIP - ALIGNING CUTS

When aligning the tracks for the back of the module, if any of the cuts of each track are misaligned, one of the tracks needs to be flipped so that all cuts of both tracks line up.

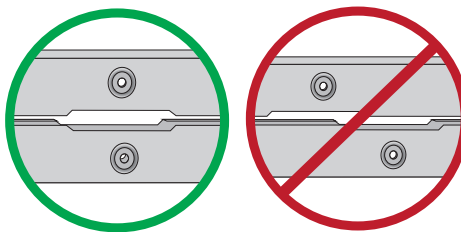

### STEP 2

Spread out the pieces to form a loose framework of the wall prior to attaching anything.

**Note:** Unlike the front wall, the center studs will be positioned within the frame and remain fixed in place.

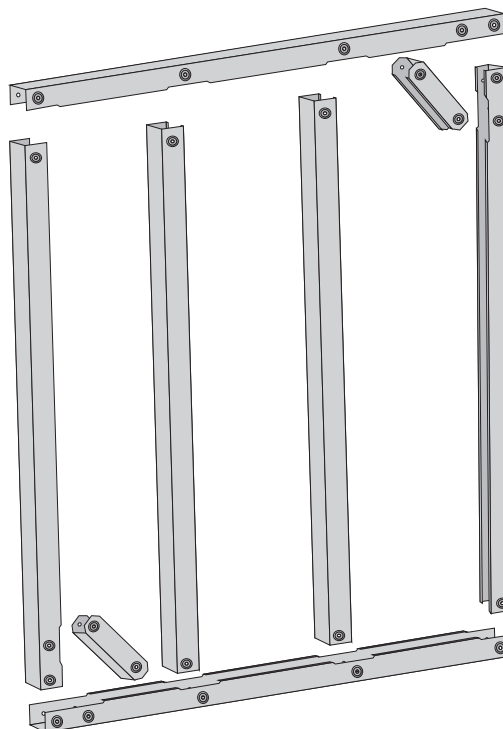

# STEP 3

Place one end of the first angle brace into the bottom track.

**Note:** You may place the angle brace into either the stud or the track first, however, it's easier to maneuver the brace into the opposite piece if you first slide your angle brace into the smaller of the two pieces.

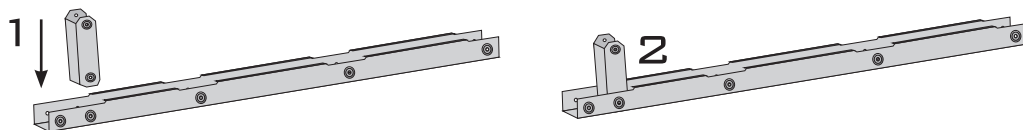

# STEP 4

Slide the other side of the angle brace into the outer left stud and then easily swing the track into place on the edge of the stud. Reconfigure the pieces so that the track rests at the bottom.

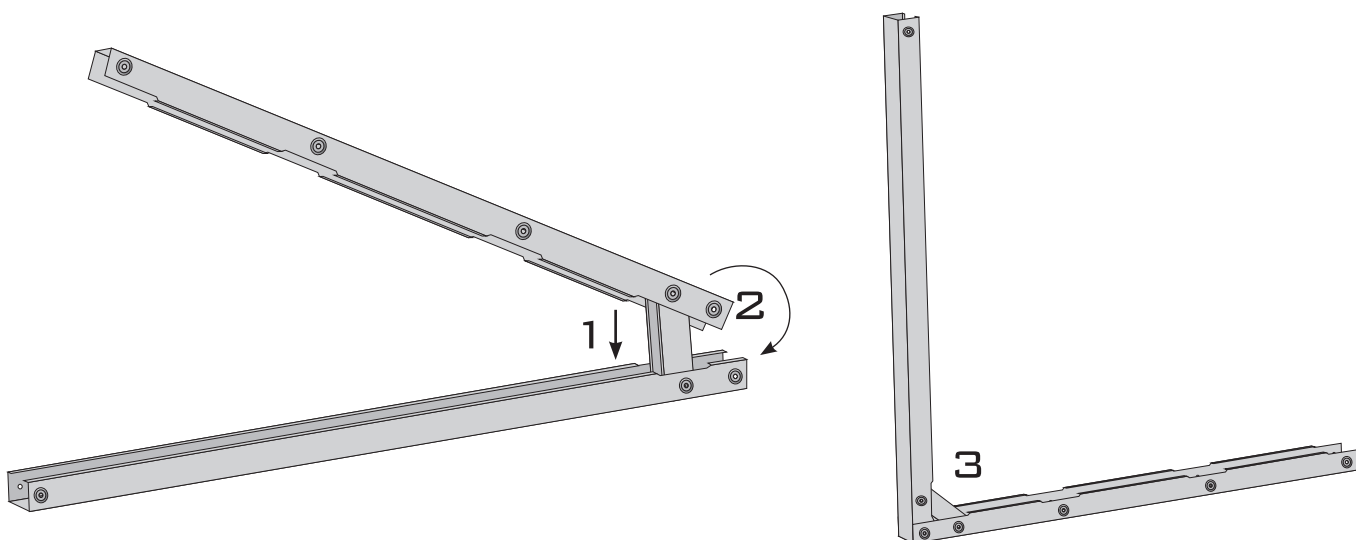

# STEP 5

Repeat steps 3 and 4 to attach the second angle brace to the opposite stud and track. You should now have two L-shaped pieces.

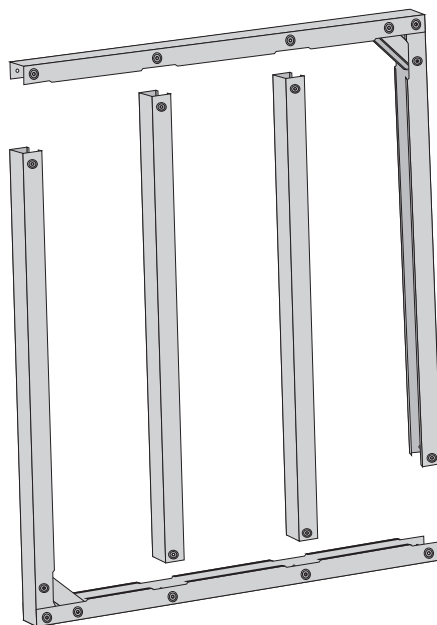

## STEP 6

Slide each center stud into the bottom track. Make sure that each of the precut holes line up.

**Note:** Each stud has a number reference, where Stud 1 will sit on the right with each number running consecutively to the left. This isn't necessary, but keeps everything organized.

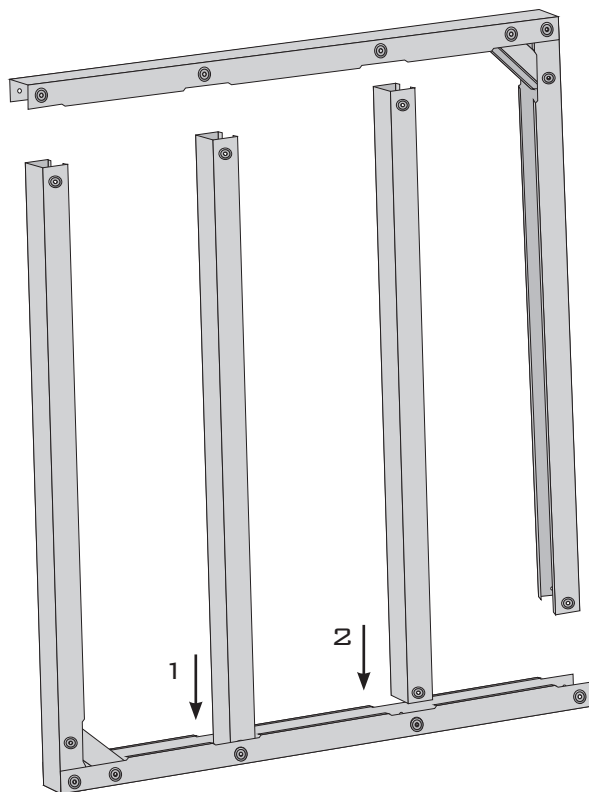

## STEP 7

Slide the second L-Shape piece into the end of the bottom track.

**Note:** When sliding the stud into the track, the top track may bend up slightly. Do not worry. This will be adjusted in the next step.

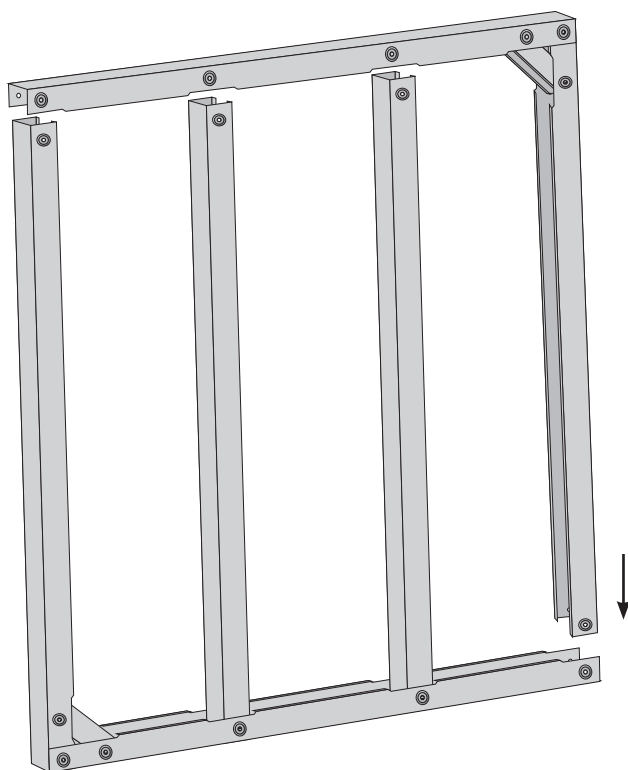

## STEP 8

Adjust the top of each stud so that they fit comfortably inside the top track. Then use the butt of your palm to carefully but firmly hit each stud into the top track so that all pre-cut holes in both the track and studs are aligned.

**Note:** If the studs do not slip right in when hit, readjust the studs and then reapply pressure to the track.

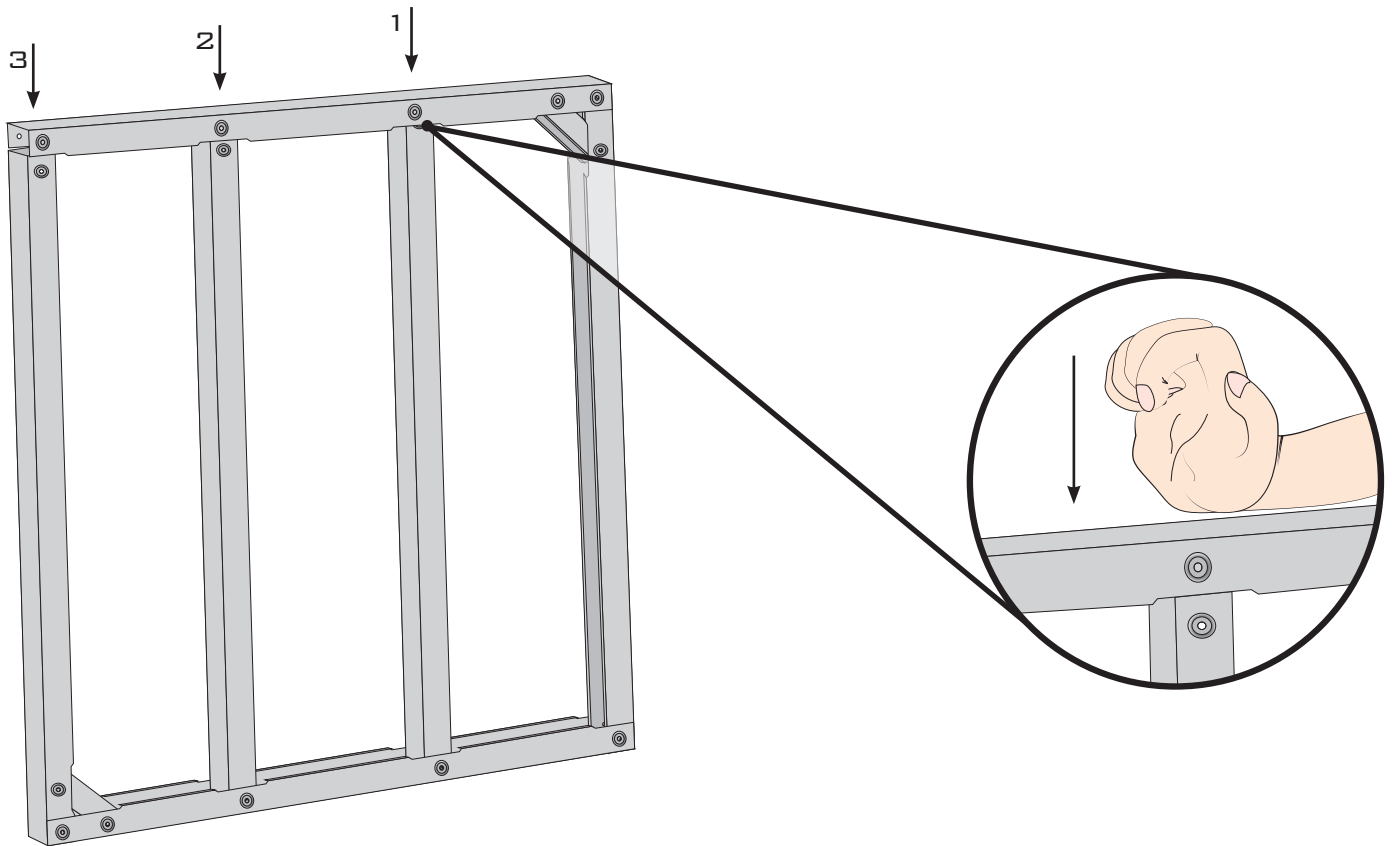

## STEP 9

Drill screws in all twelve (12) pre-drilled holes. When complete, flip the wall over and drill twelve (12) additional screws into the opposite side. You should now have a completed frame wall.

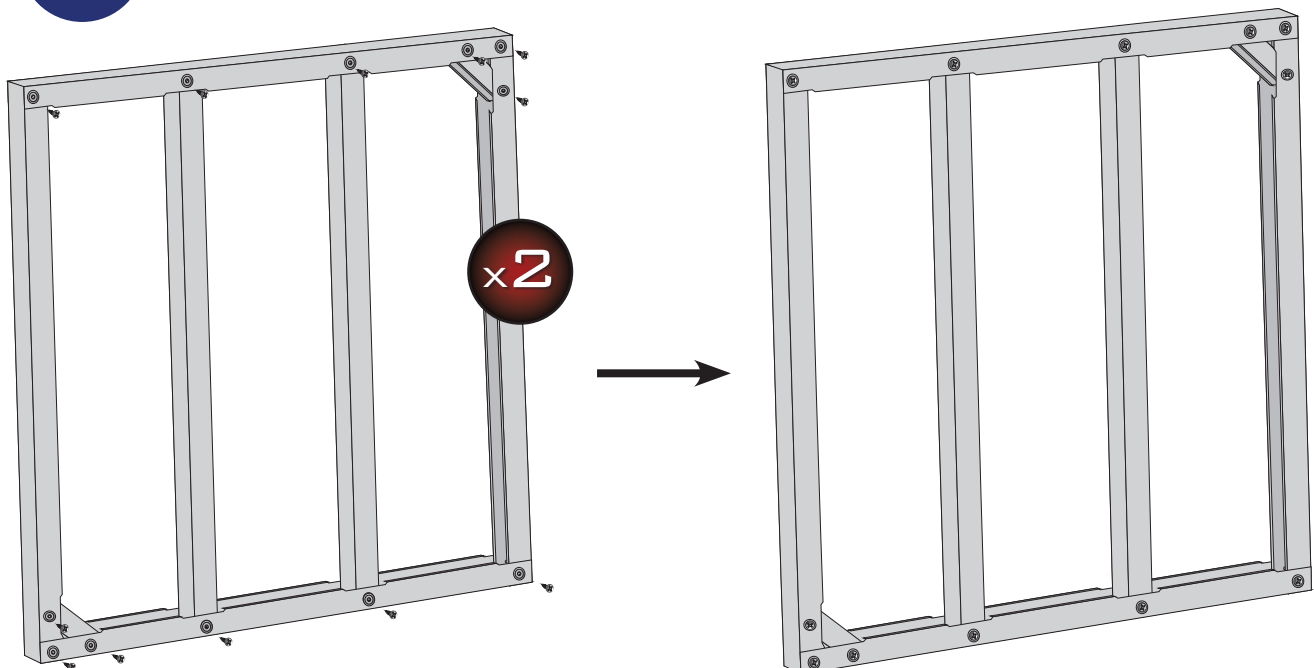

## Cross Channel (CC) Wall Assembly

### STEP 1

Align the tracks so that the double dimpled holes are opposite one another.

**Note:** When aligned correctly, the text printed on each stud will read exactly the same.

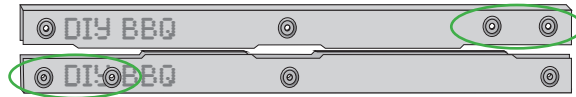

### STEP 2

Spread out the pieces to form a loose framework of the wall prior to attaching anything.

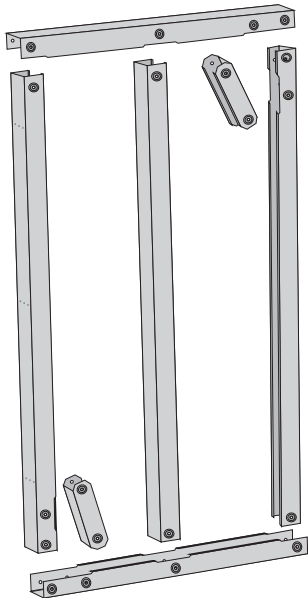

### STEP 3

Place one end of the first angle brace into the bottom track.

**Note:** You may place the angle brace into either the stud or the track first, however, it's easier to maneuver the brace into the opposite piece if you first slide your angle brace into the smaller of the two pieces.

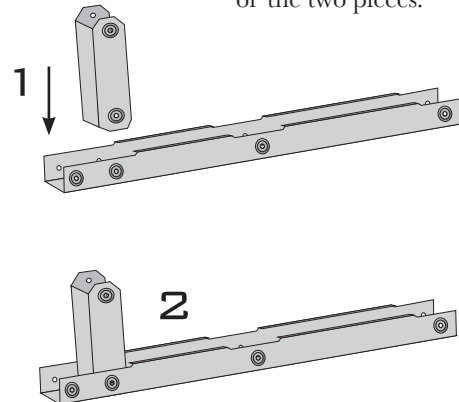

### STEP 4

Slide the other side of the angle brace into the corresponding stud and then easily swing the track into place on the edge of the stud. Reconfigure the pieces so that the track rests at the bottom.

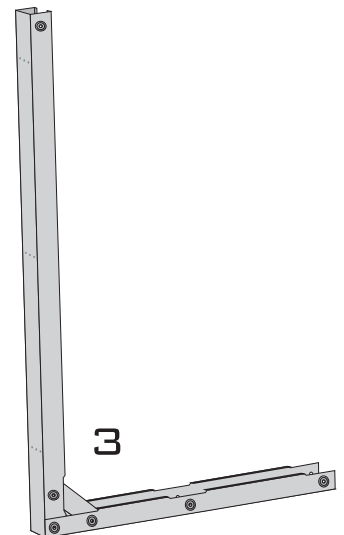
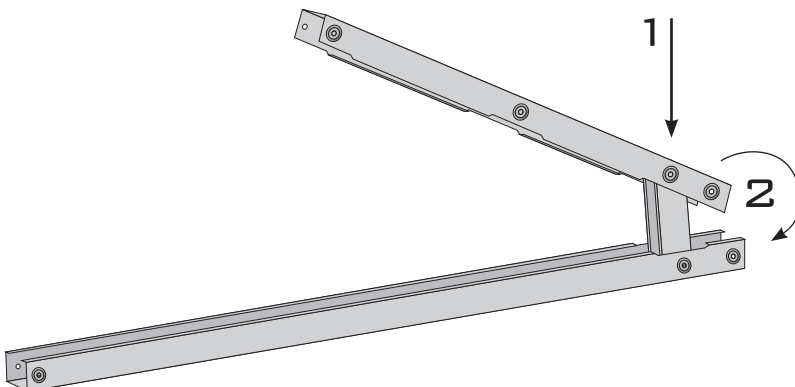

## STEP 5

Repeat steps 3 and 4 to attach the second angle brace to the opposite stud and track. You should now have two L-shaped pieces.

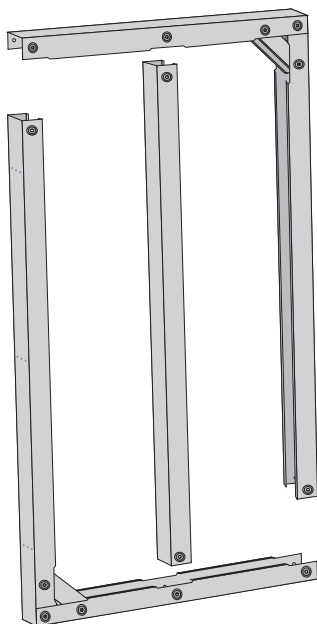

## STEP 6

Slide the center stud into the bottom track. Make sure that the precut holes match up.

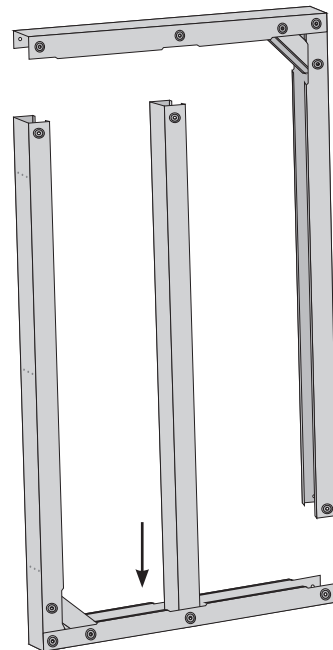

## STEP 7

Slide the second L-Shape piece into the open end of the bottom track. **Note:** When sliding the stud into the track, the top track may bend up slightly. Do not worry. This will be adjusted in the next step.

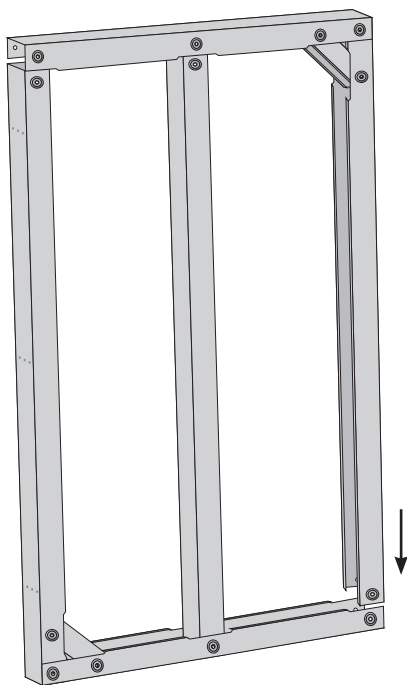

## STEP 8

Adjust the top of each stud so that they fit comfortably inside the top track. Then use the butt of your palm to carefully, but firmly, hit each stud into the top track so that all precut holes in both the track and studs are aligned.

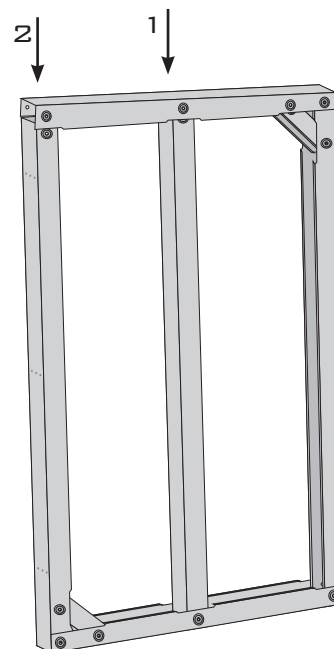

# STEP 9

Drill screws in all ten (10) pre-drilled holes. When complete, flip the wall over and drill ten (10) additional screws into the opposite side. You should now have a completed frame wall.

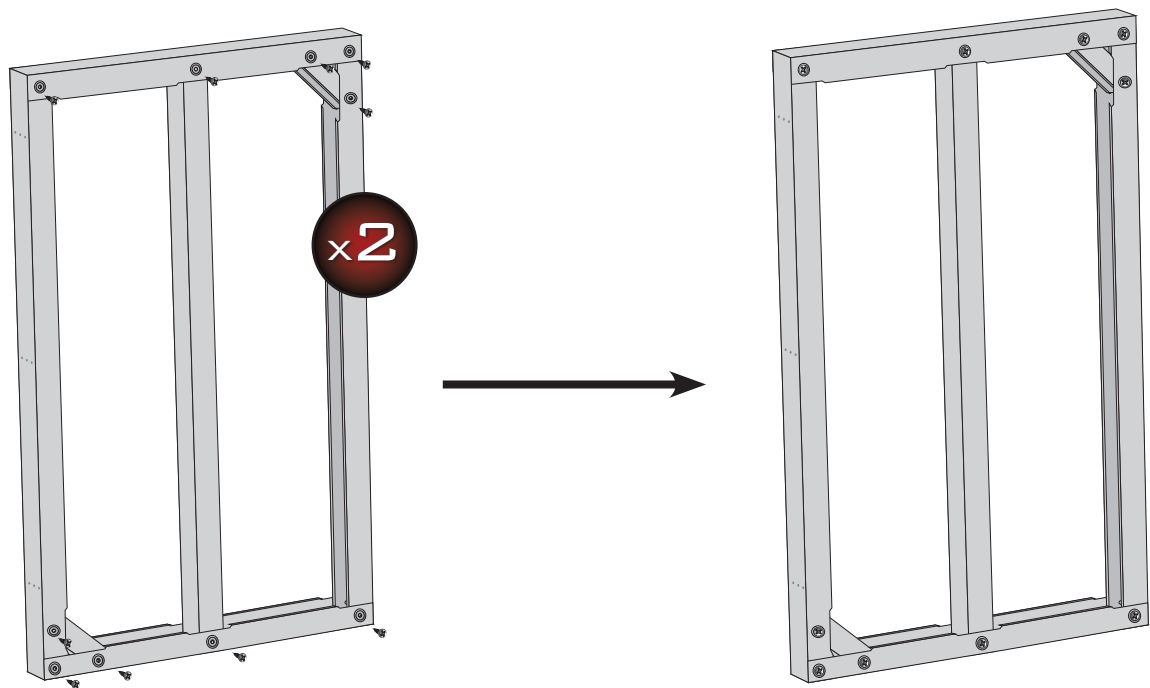

# STEP 10

Repeat steps 1 through 9 for the second CC wall. You should now have two complete Cross Channel walls.

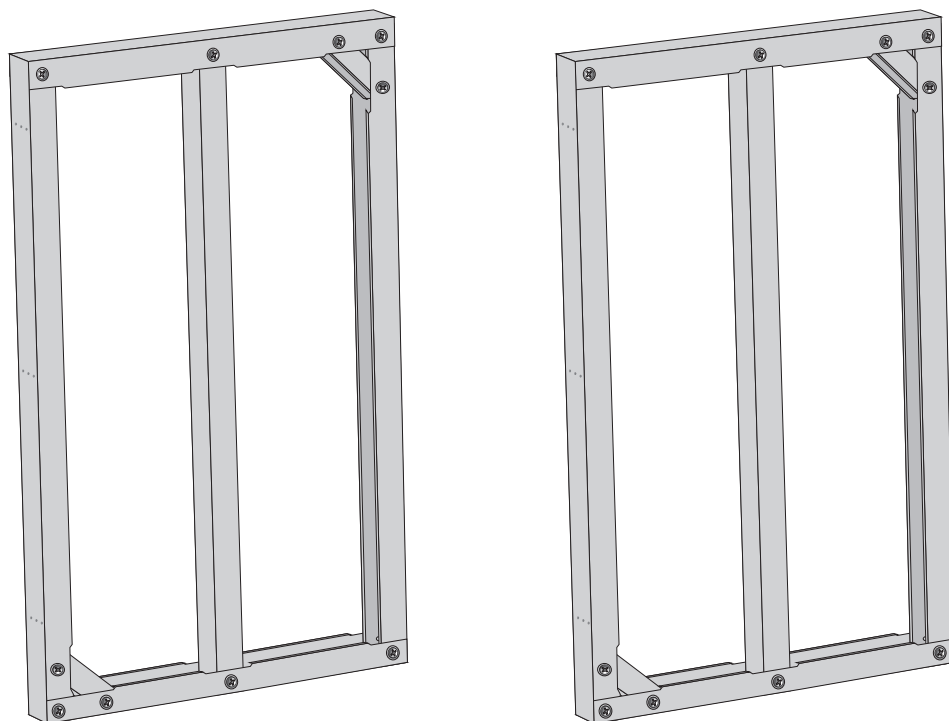



## STEP 1

Make sure you have all of your assembled pieces.

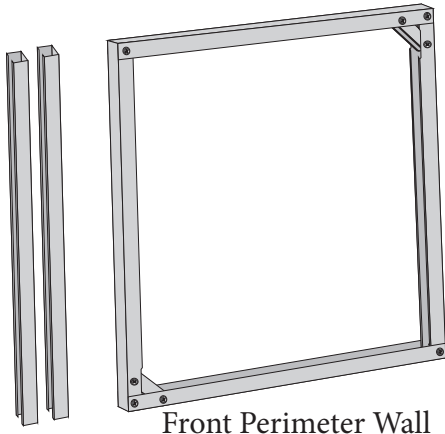

Front Perimeter Wall

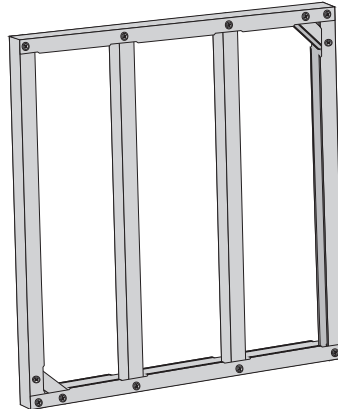

Back Perimeter Wall

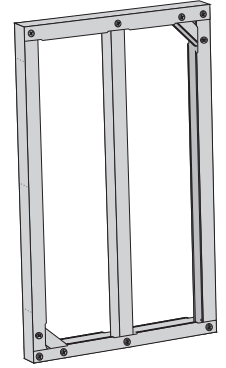
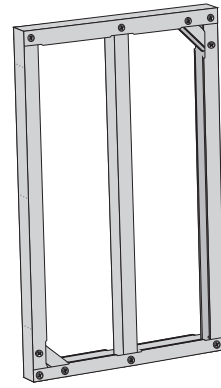

Cross Channel (CC) Walls

## STEP 2

Slide the left Cross Channel (CC) wall so that it aligns perpendicular to the edge of the left side of the back Perimeter wall.

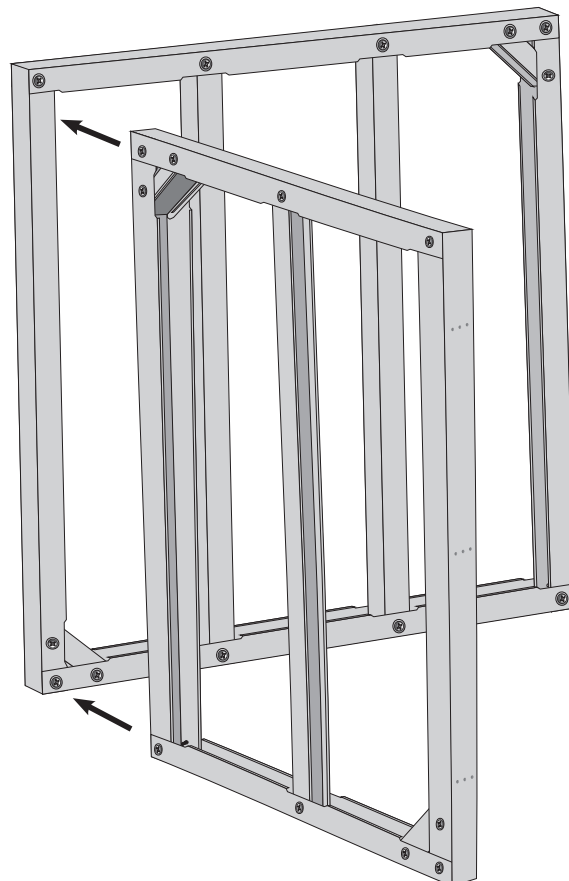

# STEP 3

Attach the CC wall to the back Perimeter wall by drilling at least five (5) screws through the pre-drilled web holes found on the inner side of the CC wall.

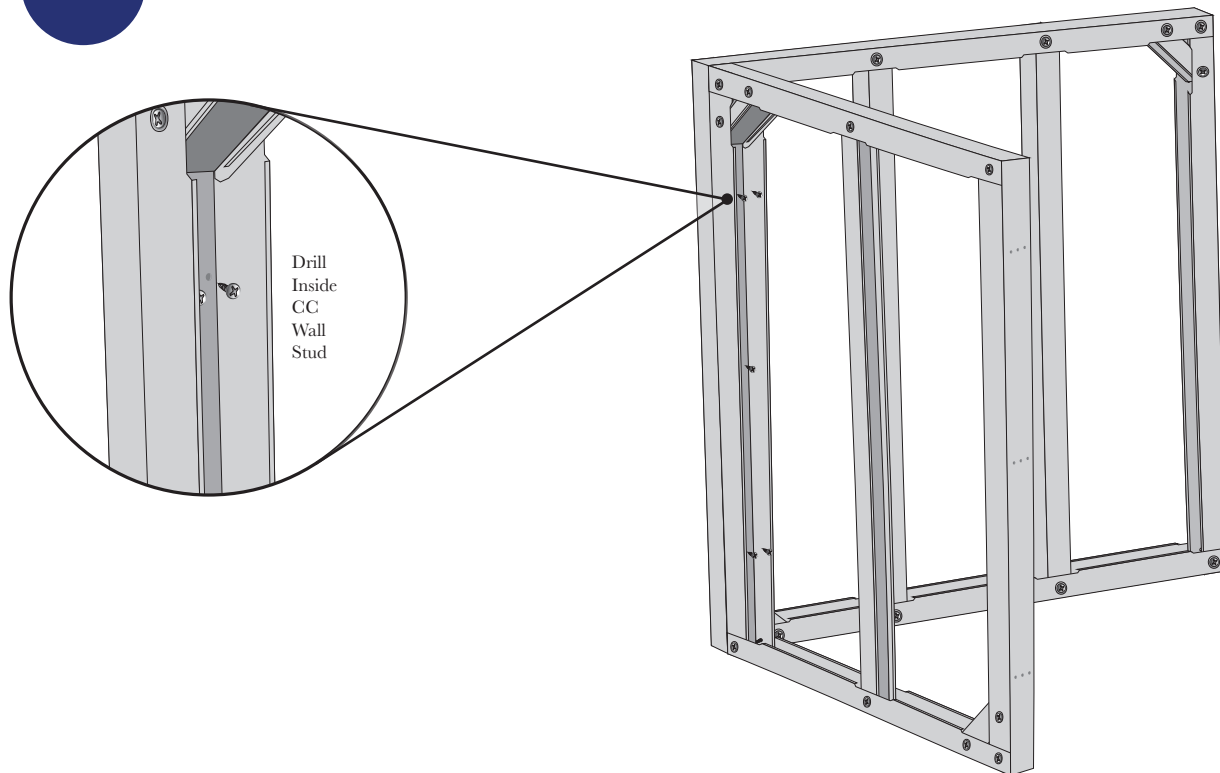

## PROFESSIONAL TIP - ATTACHING CCs TO PERIMETER WALLS

Each outer stud of a Cross Channel wall includes a series of pre-cut web holes for easy drilling. For strongest integrity, use at least two screws in the top set, one in the center set and two in the bottom.

TOP SET

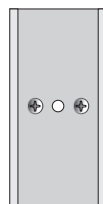

CENTER SET

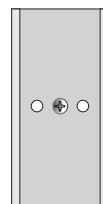

BOTTOM SET

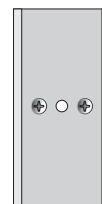

# STEP 4

Repeat steps 2 and 3 to attach the second CC wall to the right back Perimeter wall.

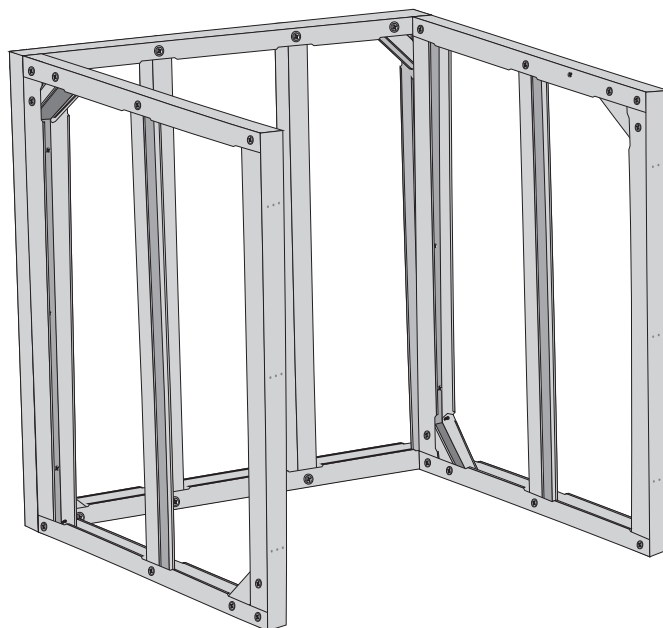

# STEP 5

Place the front Perimeter wall in place and drill screws through the web holes (as seen in step 3) to attach the front wall to both CC walls.

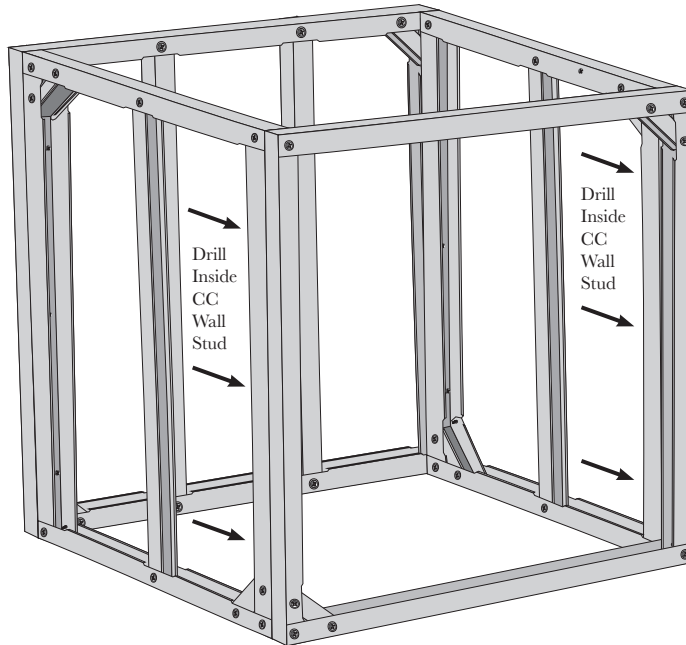

# STEP 6

You should now have a complete module. If you're ready to add your cutout modules, measure the placement for each of the inside front wall studs and drill them into place. Otherwise, you may place the front wall studs into the front wall for safe keeping until you know the dimensions and placement of your cutouts.

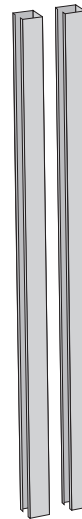
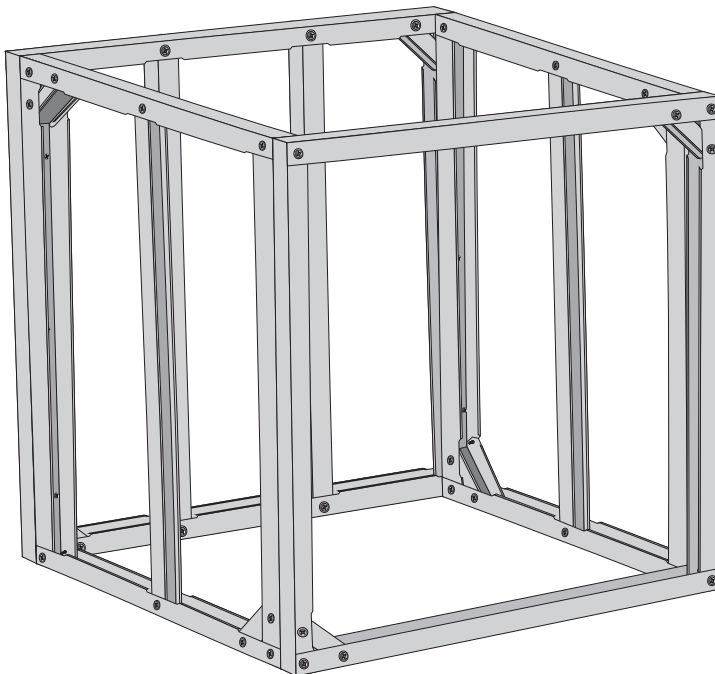

With Front Wall Studs Placed

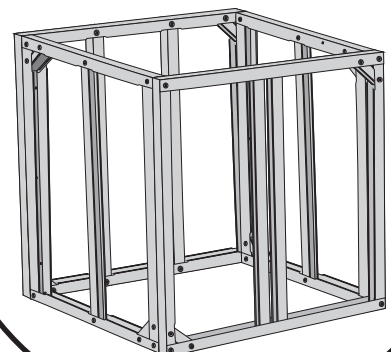

**PAGE LEFT INTENTIONALLY BLANK**

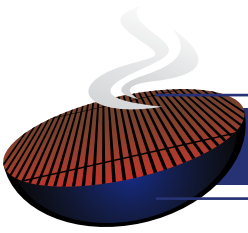

## QUICK PANEL 3-FOOT MODULE ASSEMBLY

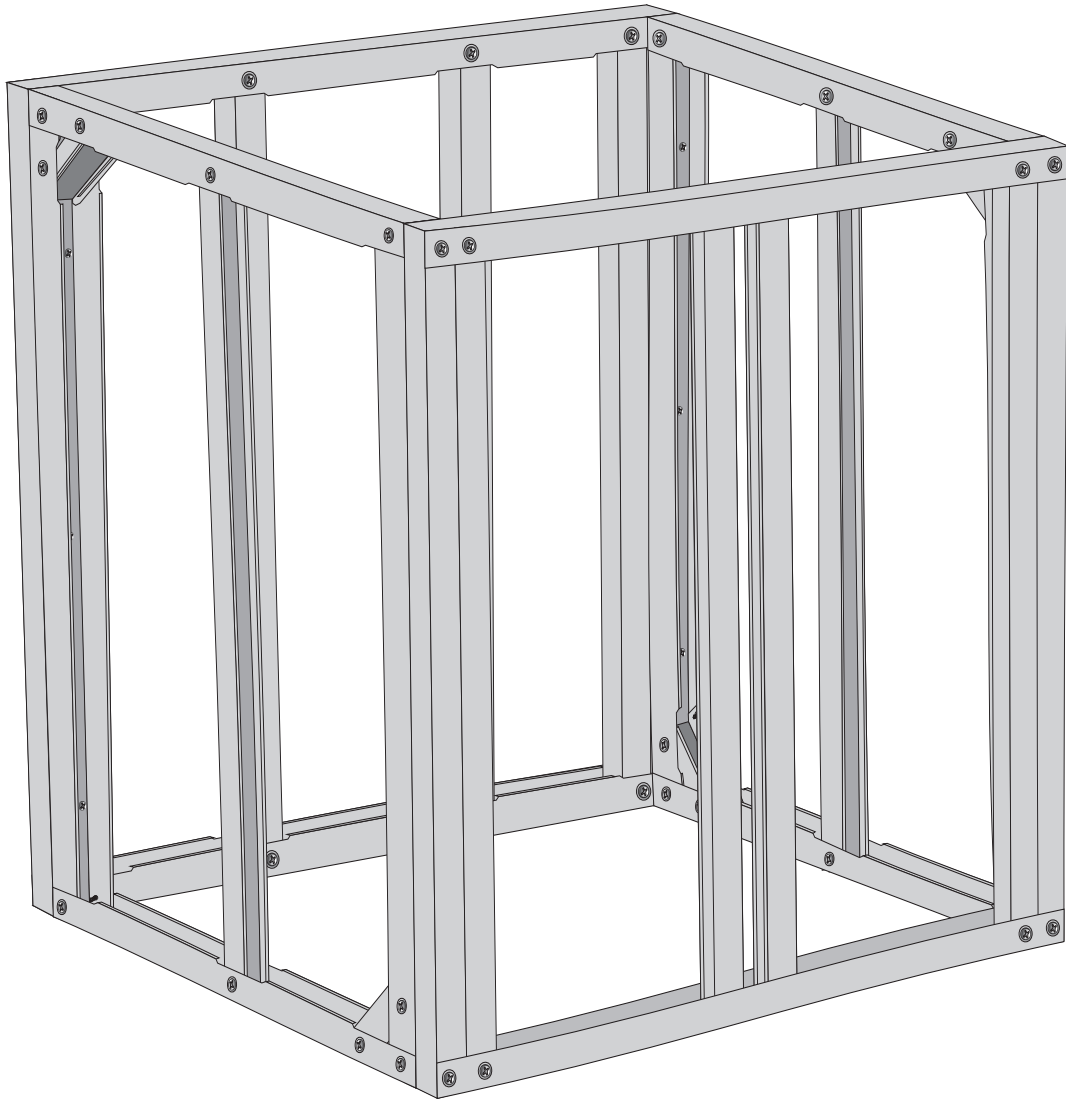

# What's in the box

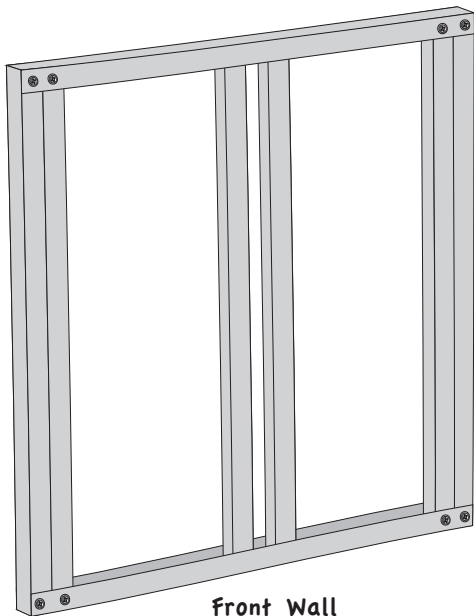

Front Wall

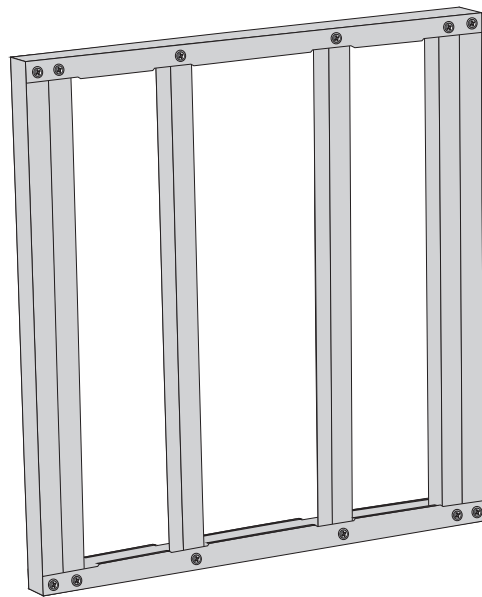

Back Wall

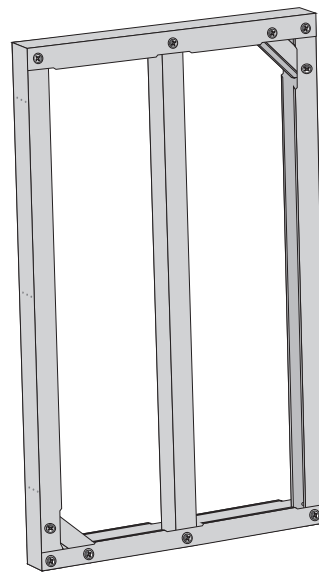
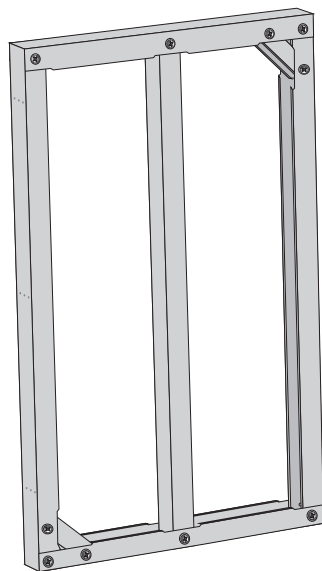

Cross Channel (CC) Walls

## CHECK LIST

- ☐ Complete Front Wall
- ☐ Complete Back Wall
- ☐ 2 Complete Cross Channel (CC) Walls
- ☐ Front Wall Studs (These will be packaged/taped inside the Front Wall tracks as seen above).

Self-Tapping Screws sold separately

## STEP 1

Remove the studs from the front wall and set them aside in a safe place.

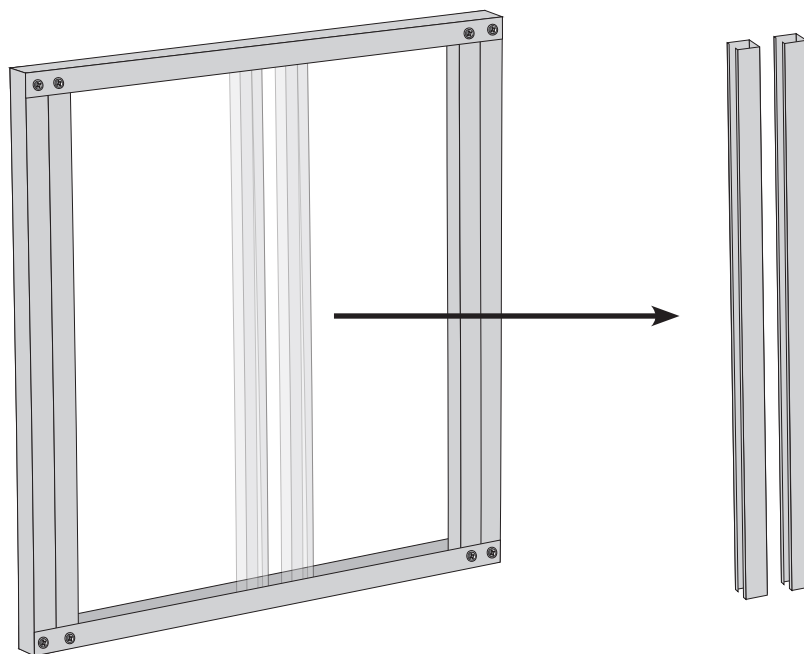

## STEP 2

Slide the left Cross Channel (CC) wall so that it aligns perpendicular to the edge of the left side of the back wall.

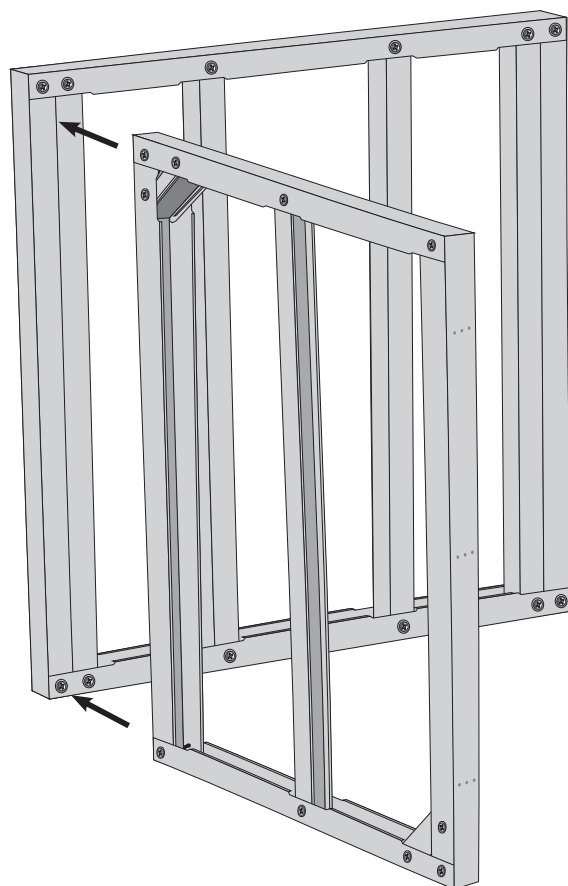

# STEP 3

Attach the CC wall to the back Perimeter wall by drilling at least 5 screws through the pre-drilled web holes found on the inner side of the CC wall.

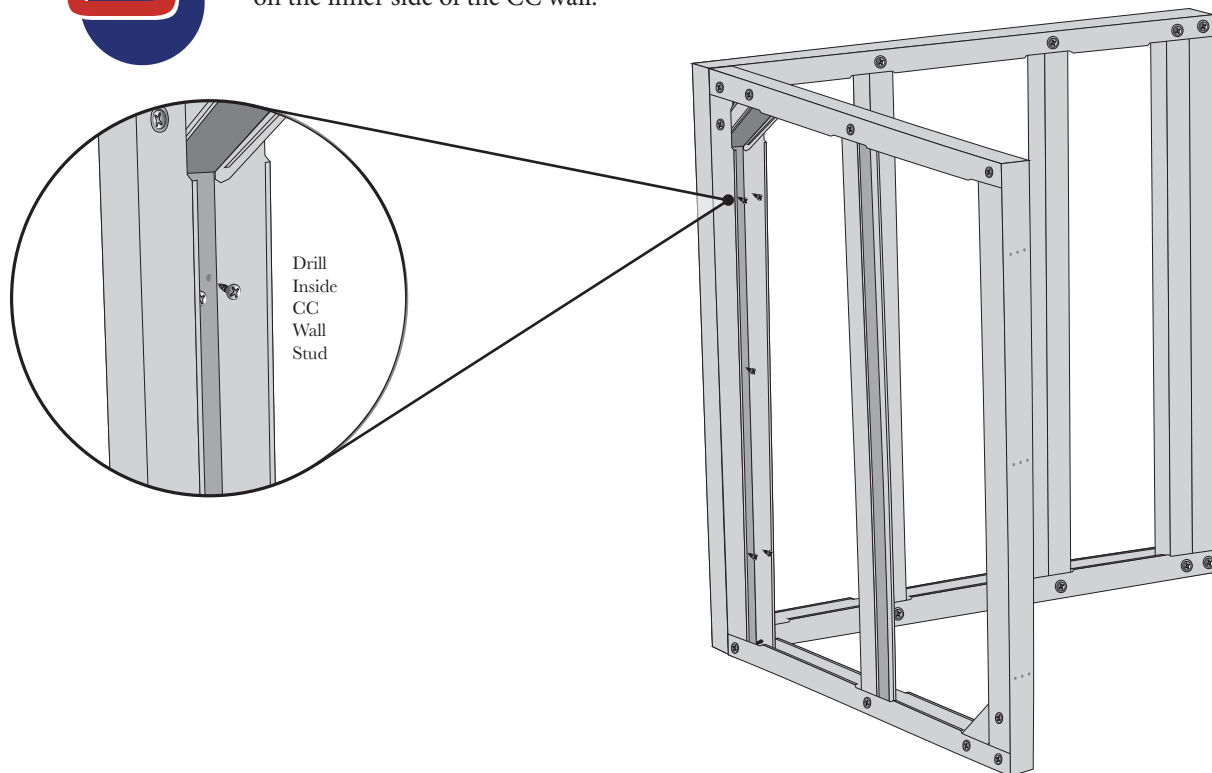

## PROFESSIONAL TIP - ATTACHING CCs TO PERIMETER WALLS

Each outer stud of a cross channel wall includes a series of pre-cut web holes for easy drilling. For strongest integrity, use at least two screws in the top set, one in the center set and two in the bottom.

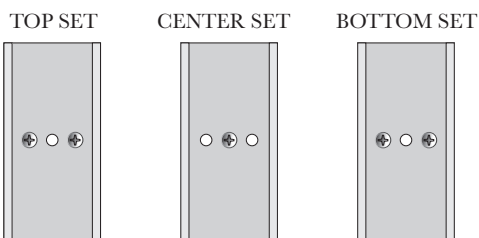

# STEP 4

Repeat steps 2 and 3 to attach the second CC wall to the right back Perimeter wall.

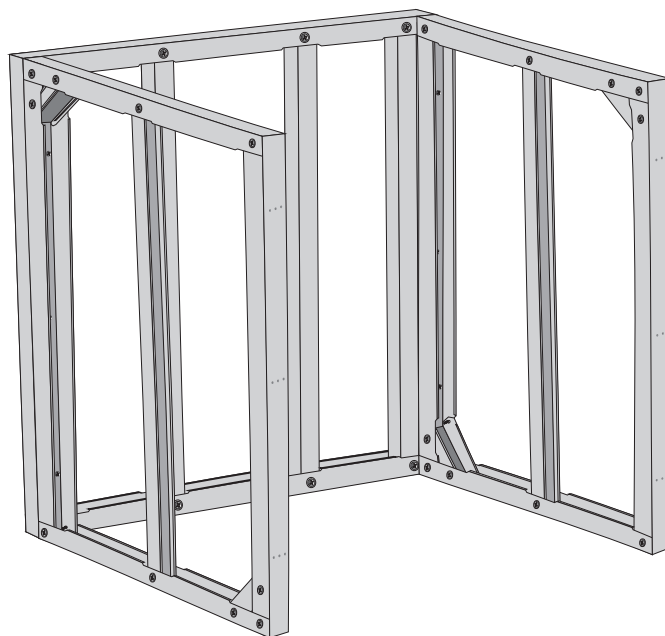



# STEP 5

Place the front Perimeter wall in place and drill screws through the web holes (as seen in step 3) to attach the front wall to both CC walls.

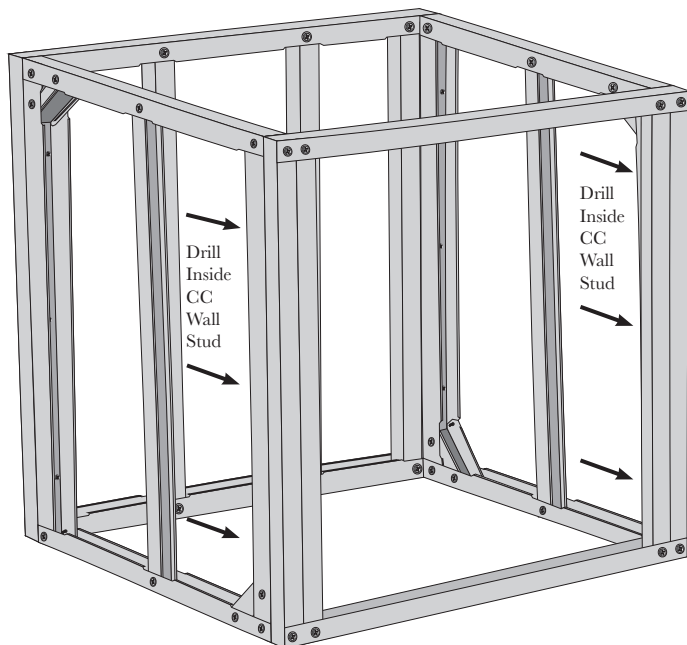

# STEP 6

You should now have a complete module. If you're ready to add your cutout modules, measure the placement for each of the inside front wall studs and drill them into place. Otherwise, you may place the front wall studs into the front wall for safe keeping until you know the dimensions and placement of your cutouts.

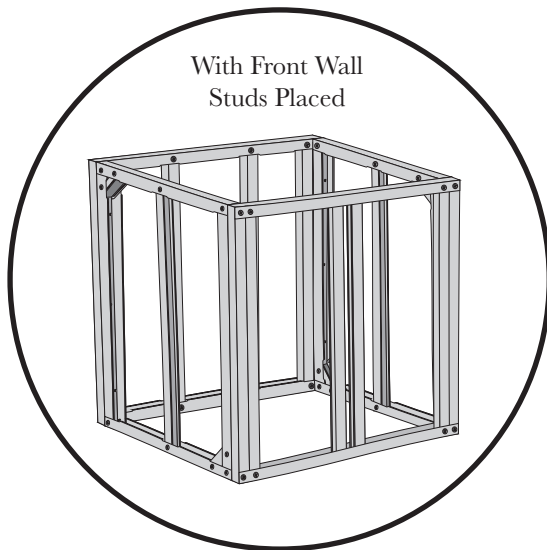
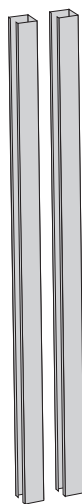
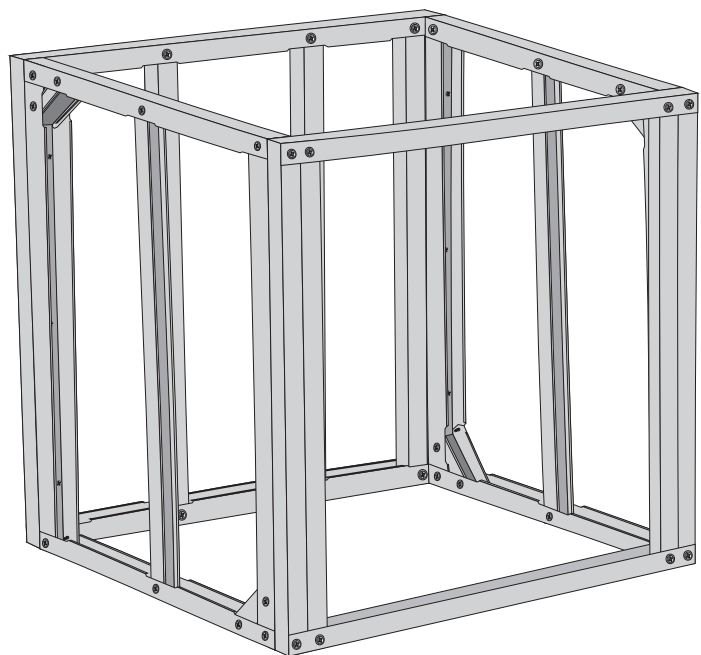

## 3-FOOT BACKSPLASH ASSEMBLY

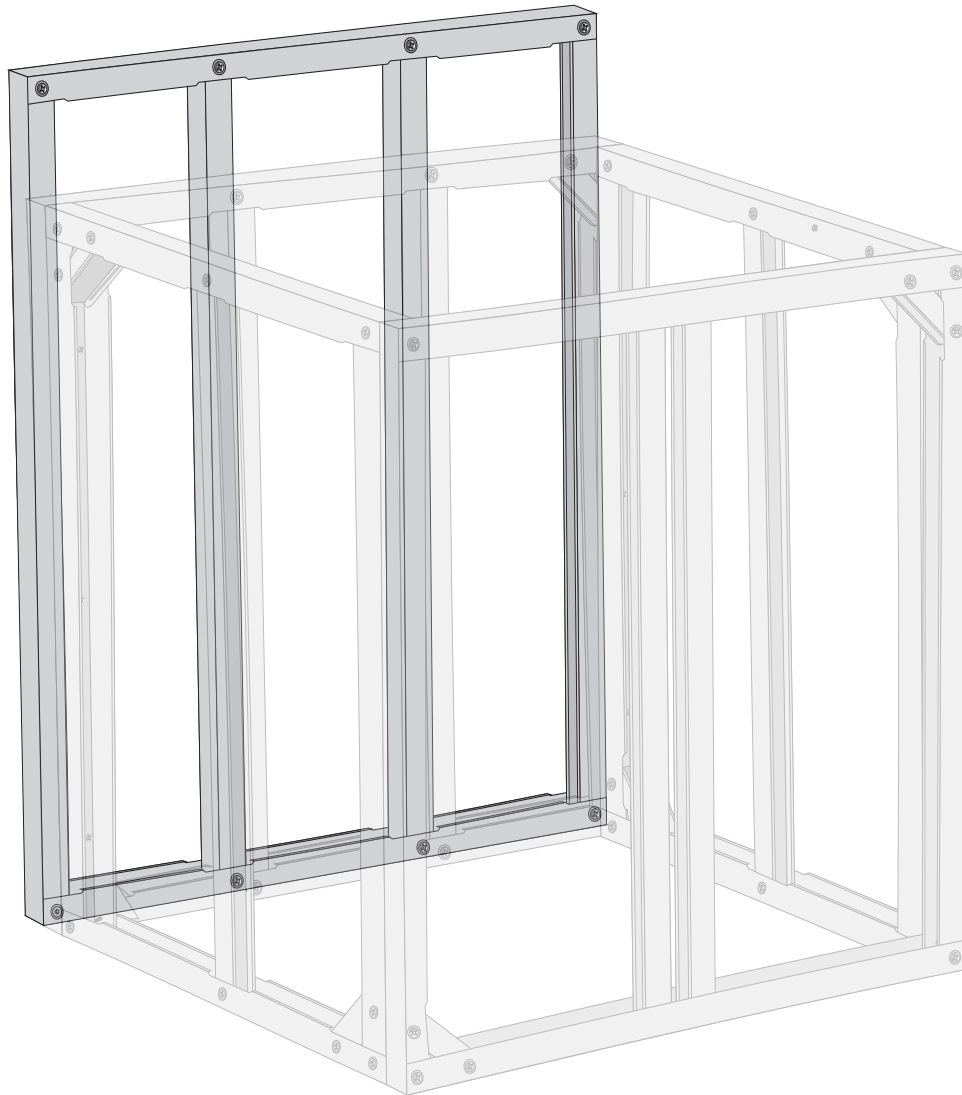
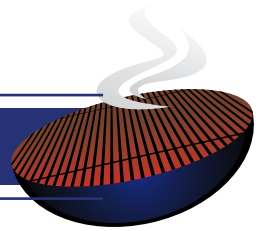

# What's in the box

Tracks

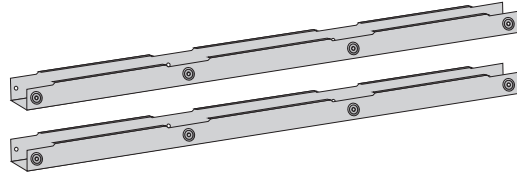

Studs

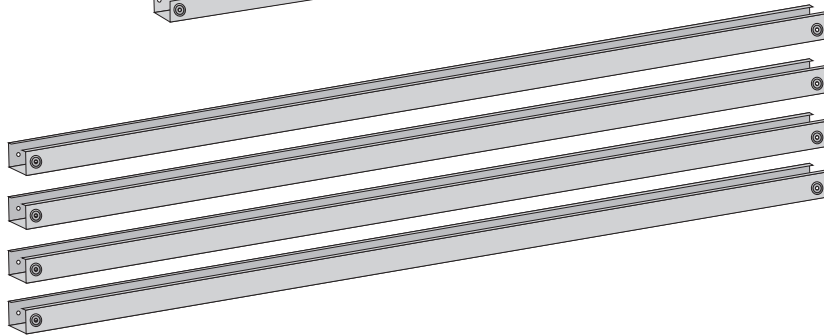

Self-Tapping Screws



## CHECK LIST

- ☐ 2 Tracks
- ☐ 4 Studs
- ☐ 16 Self-Tapping Screws

## STEP 1

Align the tracks so that all cuts are aligned properly.  
**Note:** When aligned correctly, the text printed on each stud will read exactly the same.

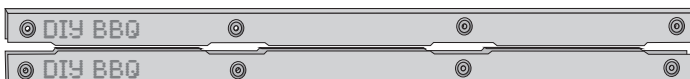

## PROFESSIONAL TIP - ALIGNING CUTS

When aligning the tracks for the back of the module, if any of the cuts of each track are misaligned, one of the tracks needs to be flipped so that all cuts of both tracks line up.

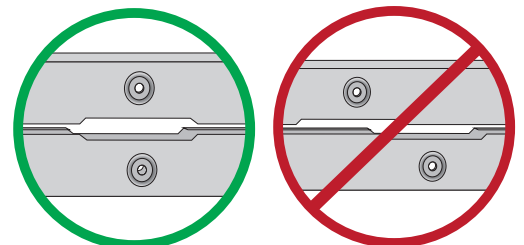

## STEP 2

Spread out the pieces to form a loose framework of the Backsplash prior to attaching anything.

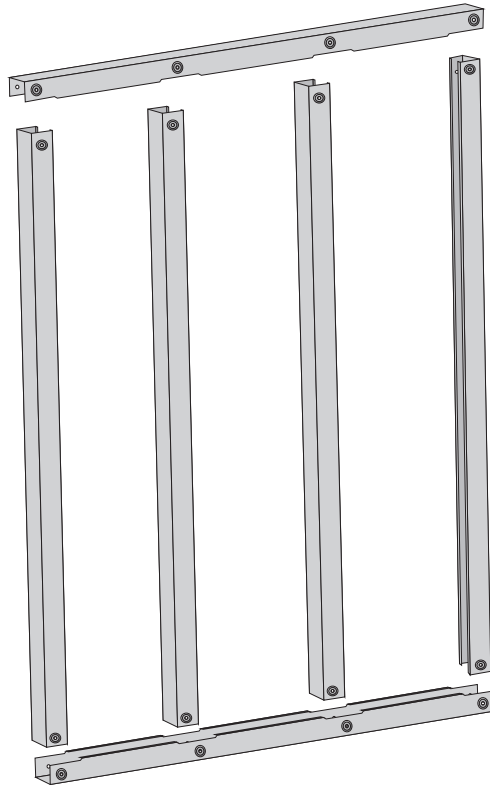

## STEP 3

Slide each stud into the bottom track. Make sure that each of the precut holes match up.

**Note:** Each stud has a number reference, where Stud 1 will sit on the right with each number running consecutively to the left. This isn't necessary, but keeps everything organized.

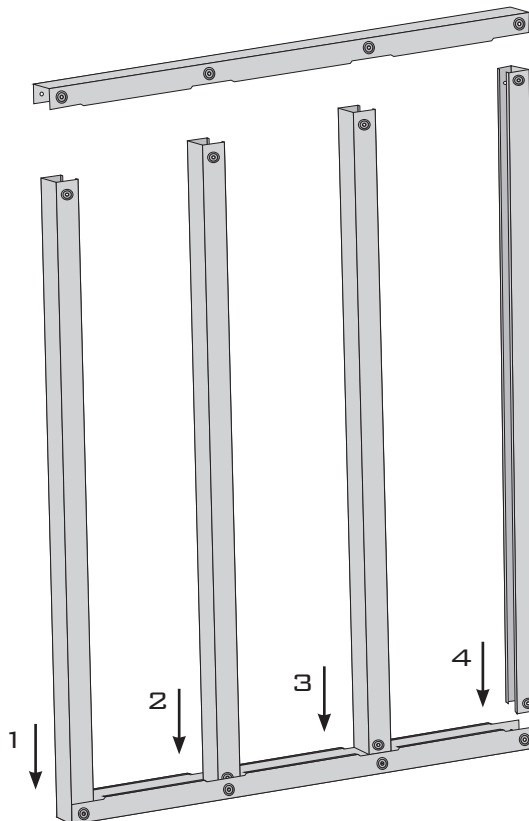

# STEP 4

Slide the top track down and adjust the top of each stud so that they fit comfortably inside the top track.



# STEP 5

Use the butt of your palm to carefully but firmly hit each stud into the top track so that all precut holes in both the track and studs are aligned.

**Note:** If the studs do not slip right in when hit, readjust the studs and reapply pressure to the track.

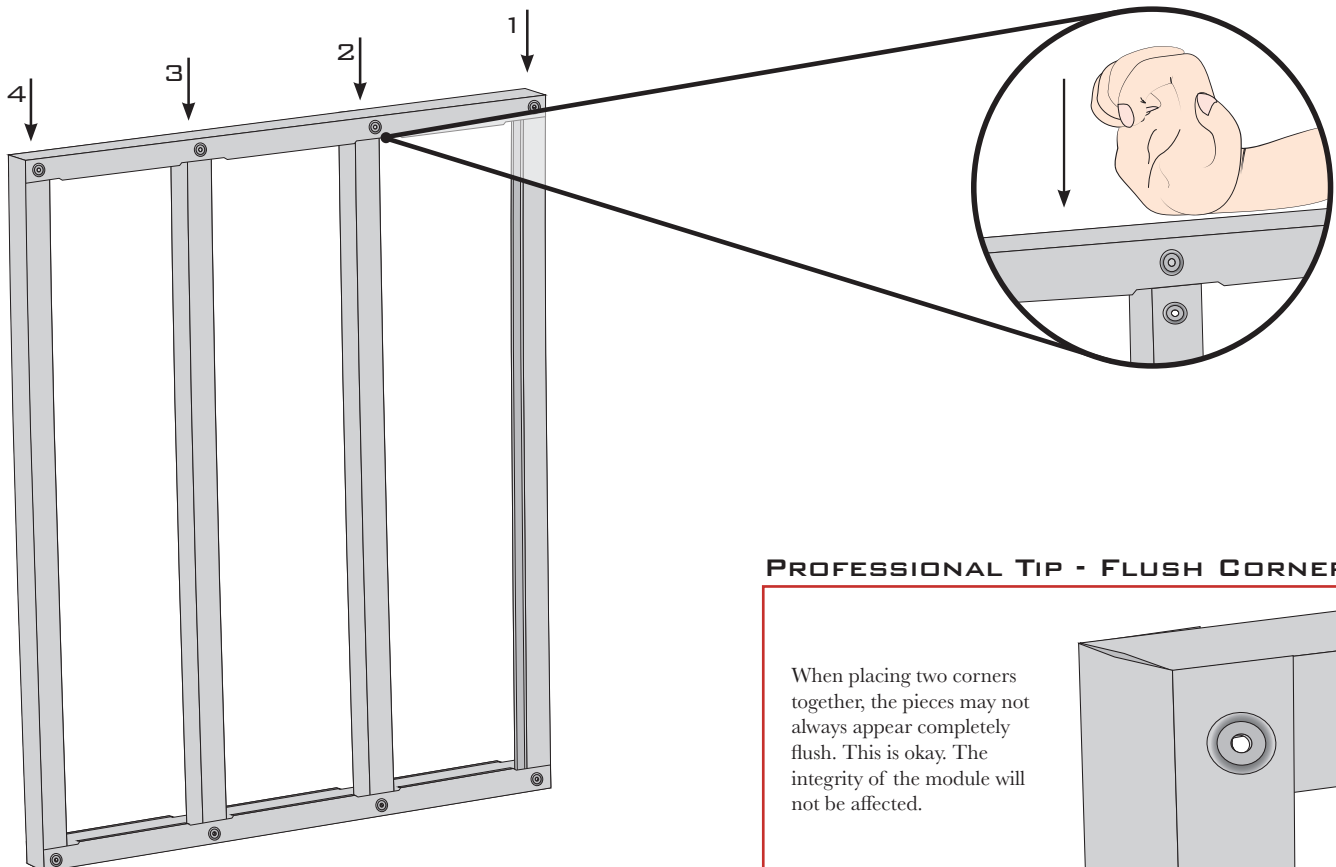

## PROFESSIONAL TIP - FLUSH CORNERS

When placing two corners together, the pieces may not always appear completely flush. This is okay. The integrity of the module will not be affected.

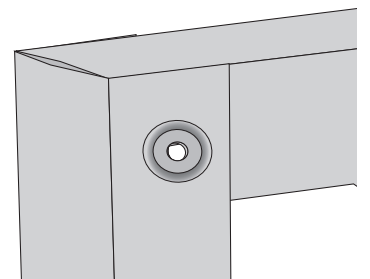

# STEP 6

Drill screws in all eight (8) pre-drilled holes. When complete, flip the wall over and drill eight (8) additional screws into the opposite side. You should now have a completed Backsplash.

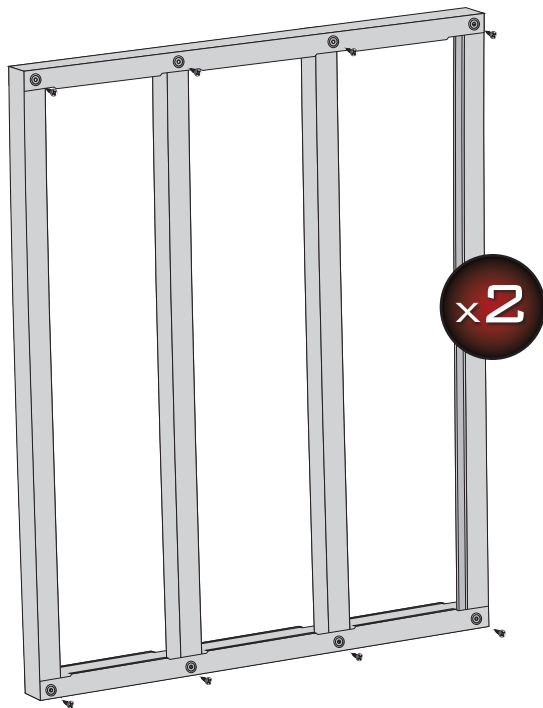

## PROFESSIONAL TIP - UNEVEN HOLES

The pre-drilled holes in two pieces may not always align perfectly. If this is the case, simply angle the screw into the opening of both holes and then twist up while drilling.

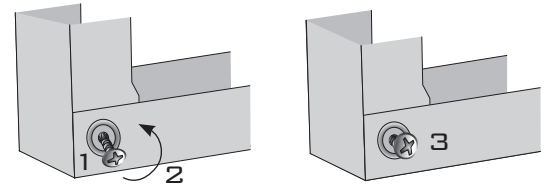

# STEP 7

To attach the Backsplash to your module, use two union plates, one at the top and one at the bottom, on each side of the module. Using six (6) screws in each plate will provide a strong attachment, however any amount from two to 23 may be used.

**Note:** Union plates and screws for the plates are sold separately.

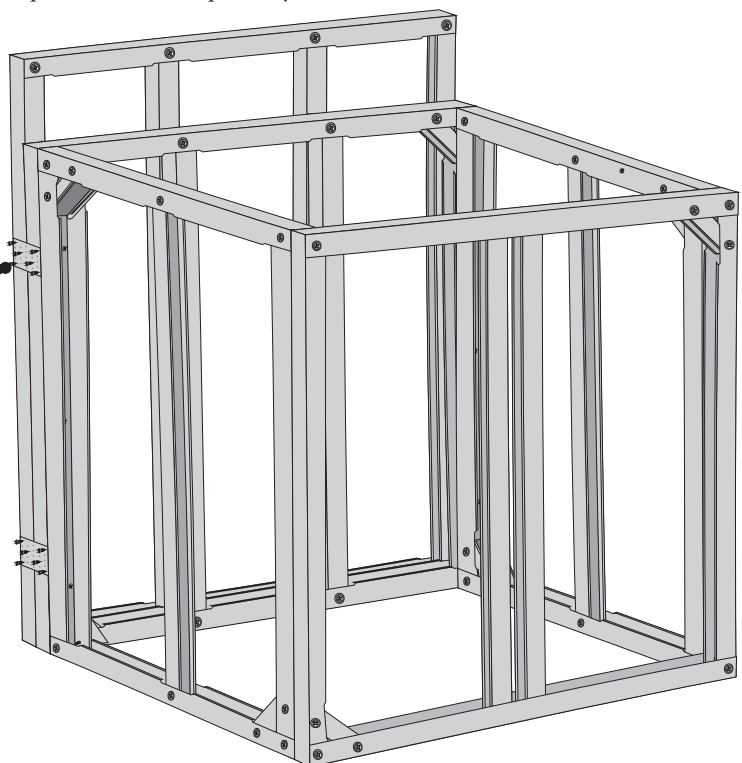
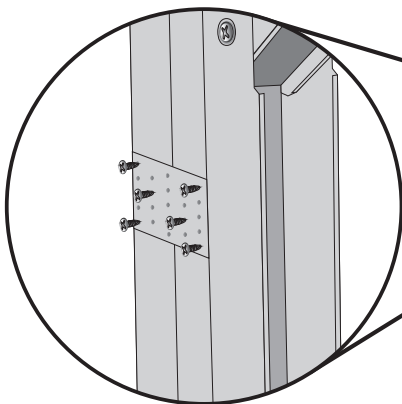

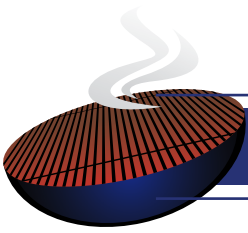

## 3-FOOT OVERHANG ASSEMBLY



# What's in the box

Tracks

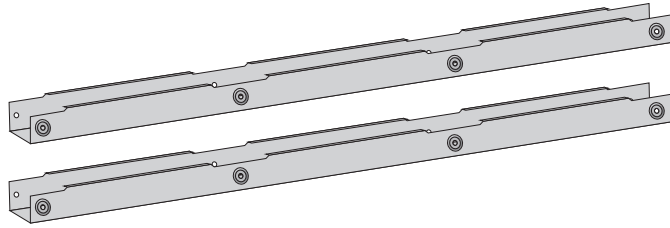

Studs

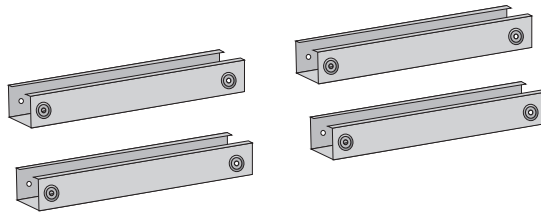

Self-Tapping Screws



## CHECK LIST

- ☐ 2 Tracks
- ☐ 4 Studs
- ☐ 16 Self-Tapping Screws

## STEP 1

Align the tracks so that all cuts are aligned properly.  
**Note:** When aligned correctly, the text printed on each stud will read exactly the same.



## PROFESSIONAL TIP - ALIGNING CUTS

When aligning the tracks for the back of the module, if any of the cuts of each track are misaligned, one of the tracks needs to be flipped so that all cuts of both tracks line up.

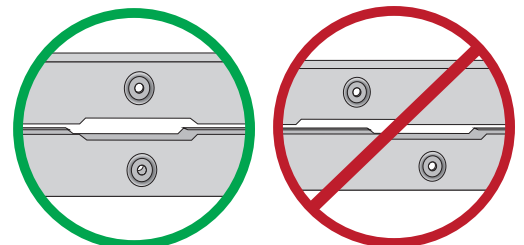



## STEP 2

Spread out the pieces to form a loose framework of the wall prior to attaching anything.

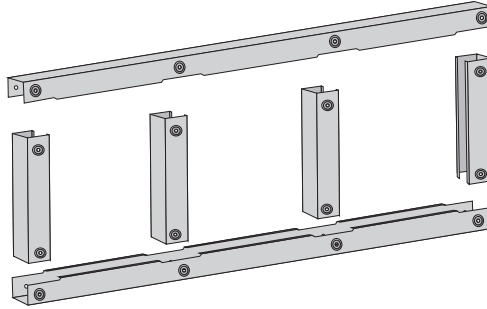

## STEP 3

Slide each stud into the bottom track. Make sure that each of the precut holes match up.

**Note:** Each stud has a number reference, where Stud 1 will sit on the right with each number running consecutively to the left. This isn't necessary, but keeps everything organized.

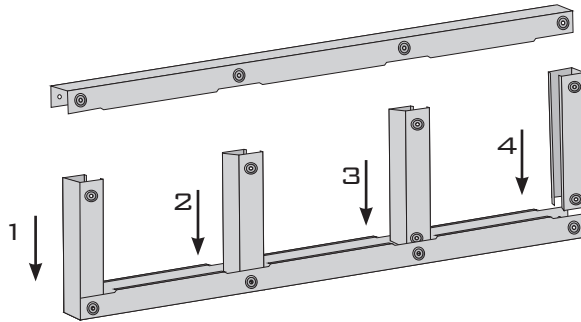

## STEP 4

Slide the top track down and adjust the top of each stud so that they fit comfortably inside the top track.

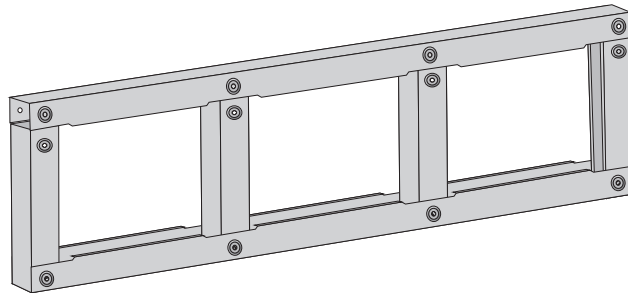

## STEP 5

Use the butt of your palm to carefully but firmly hit each stud into the top track so that all precut holes in both the track and studs are aligned.

**Note:** If the studs do not slip right in when hit, readjust the studs and reapply pressure to the track.

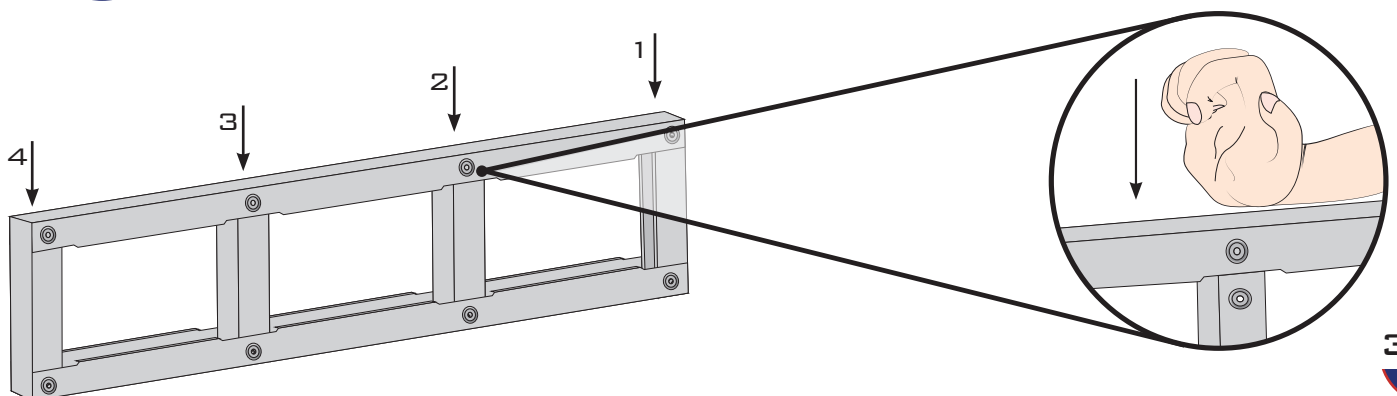

# STEP 6

Drill screws in all eight (8) pre-drilled holes. When complete, flip the wall over and drill additional eight (8) screws into the opposite side. You should now have a completed Overhang.

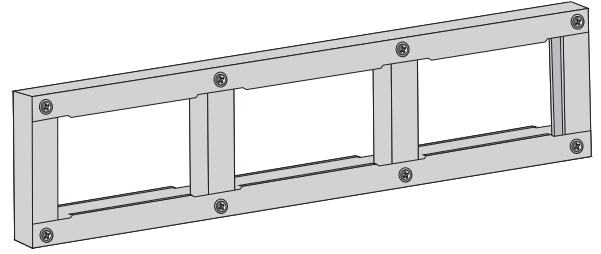
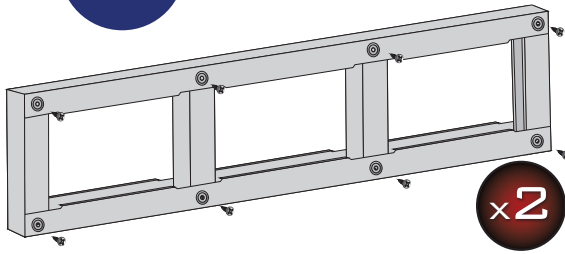

## PROFESSIONAL TIP - FLUSH CORNERS

When placing two corners together, the pieces may not always appear completely flush. This is okay. The integrity of the module will not be affected.

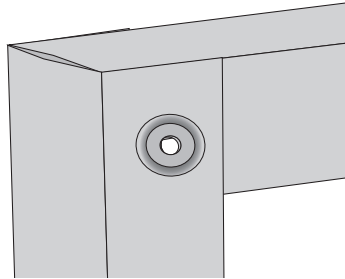

## PROFESSIONAL TIP - UNEVEN HOLES

The pre-drilled holes in two pieces may not always align perfectly. If this is the case, simply angle the screw into the opening of both holes and then twist up while drilling.

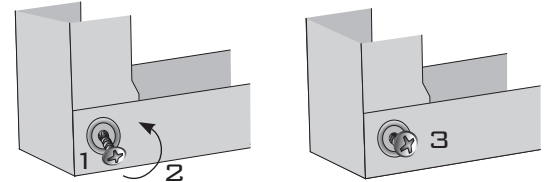

## READ BEFORE PRECEDING TO STEP 7

For a stronger foundation on your Overhang, secure an L-Bracket to each stud of the Overhang and module or Backsplash (See Steps 8-10). You may skip these steps, however, it is not recommended.

# STEP 7

To attach the Overhang to your module, use an L-Bracket on each side of the module. Using at least four (4) screws in each plate to provide a strong attachment. (Any amount from four to 10 on each may be used.)

**Note:** L-Brackets and screws for the plates are sold separately.

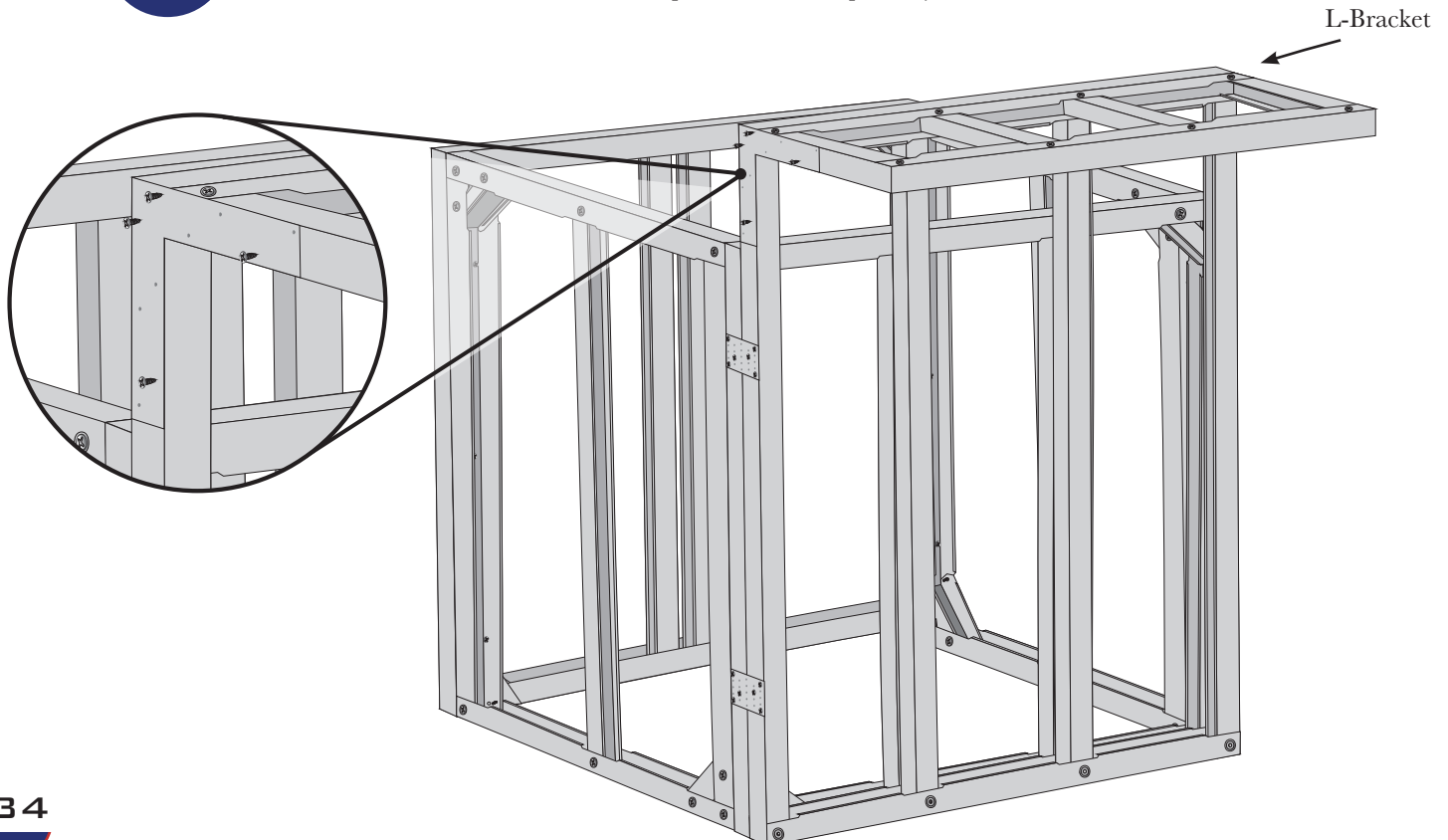

## STEP 8

For a stronger foundation on your overhang, secure an L-Bracket to each stud of the Overhang and module or Backsplash. First, use your Aviation Snips to cut a small strip in the track that will sit up against the module or Backsplash. Make sure that you are cutting on the closed side of the Overhang stud, as opposed to the open side.

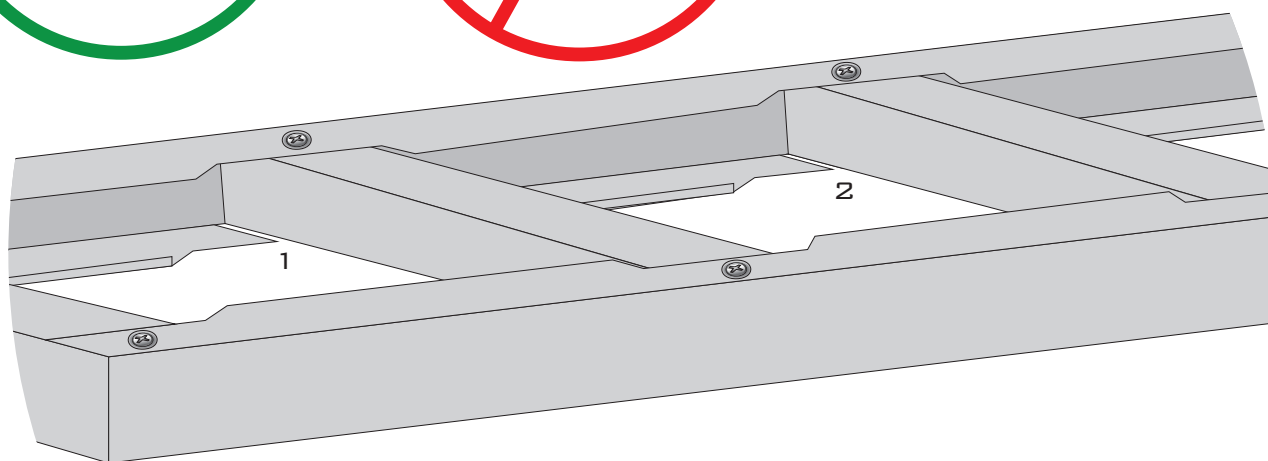
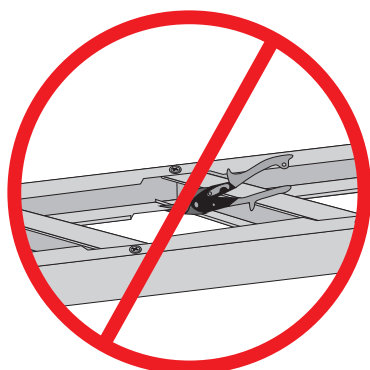
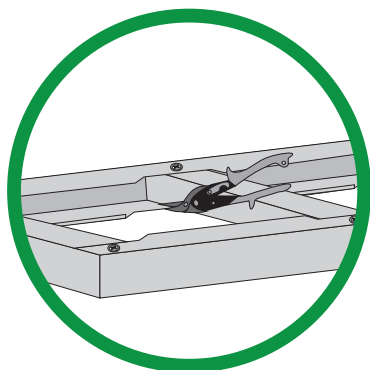

## STEP 9

Repeat step 8 for the top track of either the back Perimeter wall of the module or the Backsplash, whichever the Overhang will eventually be attached to.

## STEP 10

Slide the L-Brackets through the slits and make them flush along the studs of both the Overhang and the module or Backsplash. Then drill at least four (4) screws into each L-Bracket. Once completed, return to Step 7 to complete assembly.

