

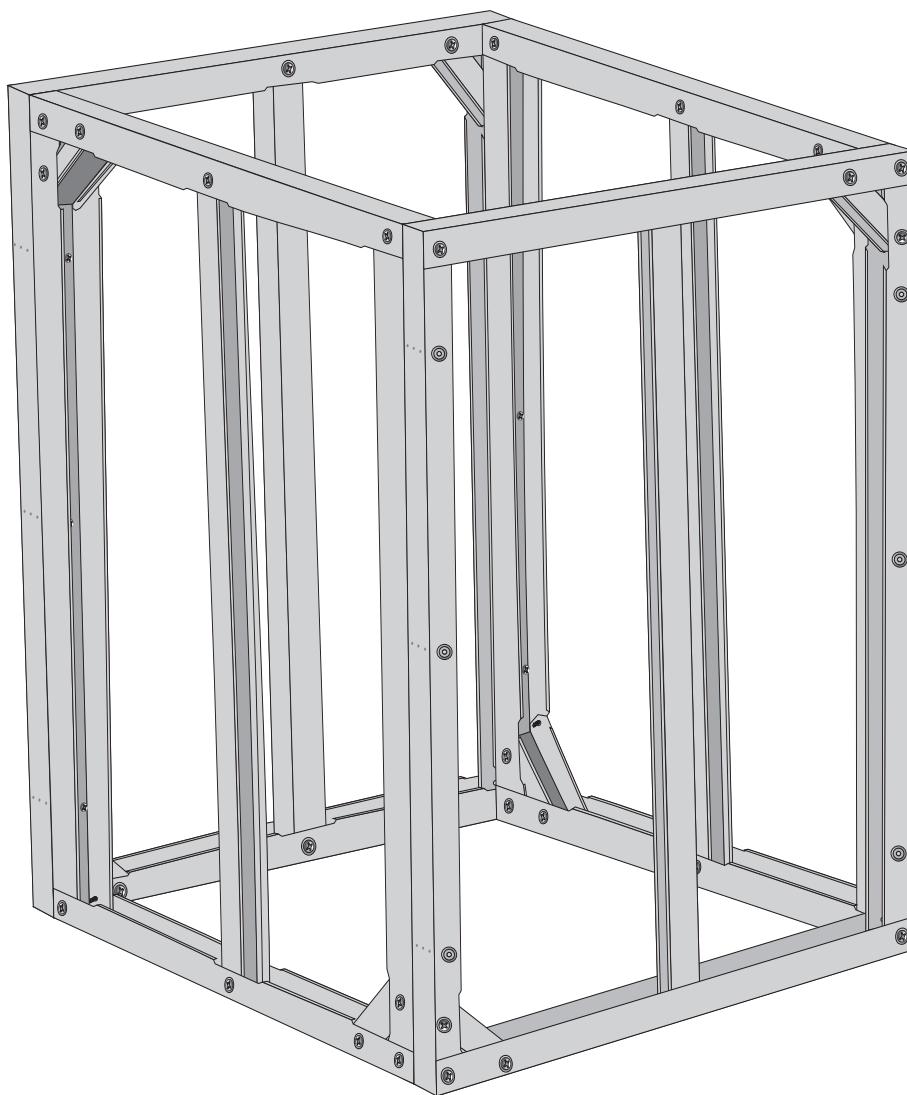

Easy-to-Follow

INSTRUCTION *Manual*

2-FOOT MODULE ASSEMBLY



COPYRIGHT NOTICE

This instruction manual is protected under Copyright Law of the United States of America.

This copy of the instruction manual is for the sole use of the original purchaser. A license to use the information contained herein is granted to the original purchaser by the author.

No part of this instruction manual, including but not limited to, photographs, pictures, diagrams, or illustrations may be reproduced, copied or transferred in print or electronically to third parties without the express written permission of the author. Any copying, retransmission, editing or distribution without the express written permission of the author will terminate the license and all copies in the possession or distribution by the purchaser will be considered unlicensed and therefore in infringement of U.S. Copyright Law.

Furthermore, if the purchaser wishes to use the information contained herein for the creation or supplement of business, whereby BBQ islands would be part of the business, then the purchaser is not permitted to use or distribute any of the enclosed information within that business without the express written permission of the author.

WARNINGS

When working with metal, the edges are very sharp and may have small splinters across the edges. Be extremely careful when handling each piece. It is highly recommended to wear safety glasses and gloves at all times while building your modules. Eye protection is required when cutting or screwing metal pieces to protect against errant metal pieces and particles.

Keep children and animals away from the metal pieces and completed frame kits.

Please follow all manufacturer directions on how to properly install BBQ products.

Check with your local codes on construction for the required permits you may need for construction of your BBQ island.

Utility lines should only be installed by a licensed plumber or electrician per the code in your area. Do not forget to get a permit if required by local laws or regulations.

Please read all directions on how to install your DIYBBQ island modules. Installation of the product is at your own risk; DIYBBQ, LLC is not liable for misuse of the module frame kits nor for damage to any of your BBQ products.

NOTICE OF LIMITED LIABILITY

NOTICE: DIYBBQ, LLC shall **NOT** be liable for incidental and consequential damages, directly or indirectly sustained to any person(s), equipment, tools, or appliances during or after the installation of any BBQ island, related directly or indirectly to the installation and operation of any BBQ island or appliances, nor for any loss caused by application of these goods not in accordance with current printed instructions or for other than the intended use. DIYBBQ, LLC's liability is expressly limited to replacement of defensive goods. Any claim shall be deemed waived unless made in writing to DIYBBQ, LLC at 26520 ADAMS AVE., MURRIETA, CA 92562 within thirty (30) days from the date it was or reasonably should have been discovered.

ARBITRATION AGREEMENT

USE OF OR PURCHASE OF ANY DIYBBQ, LLC PRODUCTS, OR ANY GOODS AVAILABLE FOR PURCHASE THROUGH DIYBBQ.COM REQUIRES THAT ALL CLAIMS BE SETTLED UNDER THIS BINDING ARBITRATION PROVISION, WHICH AFFECTS YOUR LEGAL RIGHTS AND MAY BE ENFORCED BY EITHER PARTY.

In the event a dispute shall arise between DIYBBQ, LLC and any purchaser of any DIYBBQ, LLC product or good available through diybbq.com, it is hereby agreed that the dispute shall be referred to a USA&M office to be designated by USA&M National Headquarters for Arbitration in accordance with the applicable United States Arbitration and Mediation Rules of Arbitration. **The arbitrator's decision shall be final and legally binding, and judgment may be entered therein.**

Each party shall be responsible for its share of the arbitration fees in accordance with the applicable Rules of Arbitration. In the event a party fails to proceed with arbitration, unsuccessfully challenges the arbitrator's award or fails to comply with the arbitrator's award, the other party opposing party is entitled to costs of suit, including a reasonable attorney's fee for having to compel arbitration or defend or enforce the award.

If you are still having trouble putting your module together, we are here to help. Contact us at 800-289-3492 or email support@diybbq.com.

Required Tools for Assembly

Carpenter Square

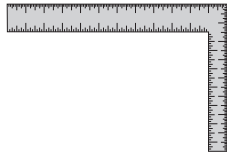

Cordless Drill



PROFESSIONAL TIPS

Proper Safety equipment is extremely important.

Always wear safety glasses and gloves when assembling your modules.

Using proper tools will make the project much easier to do and will help you obtain a properly built project. This list is of the basic tools you'll need to build your modules. You may use whatever tools you deem necessary to complete your project in the easiest way possible. All tools listed here and others you may wish to acquire can be found at Lowes®, Home Depot®, Amazon and other on-line retailers.

A cordless impact driver will make steel frame assembly easier and help protect the edges of the HardieBacker® cement board from cracking during installation onto the frame.

Useful Terms

Perimeter Walls: The front and back walls of a module.

Cross Channels: The side walls of a module that connect to the Perimeter walls.

Track: The top and bottom pieces of a Perimeter or Cross Channel wall.

Stud: The sides and inside pieces of a Perimeter or Cross Channel wall.

Angle Brace: A piece that supports the tracks to the outer studs of the front and back walls of an unassembled module.

Dimple: The indentation around a precut hole within a track or a stud.

Web Holes: The small, precut holes, usually appearing in sets of three on the back side of a Cross Channel wall that act as a guide for drilling when attaching Cross Channel walls to the front and back walls of a module.

Assuage: The small creases that appear on the ends of a stud that allows for easier assembly (see image to right).

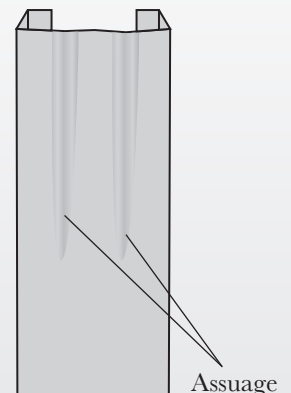

What's in the box

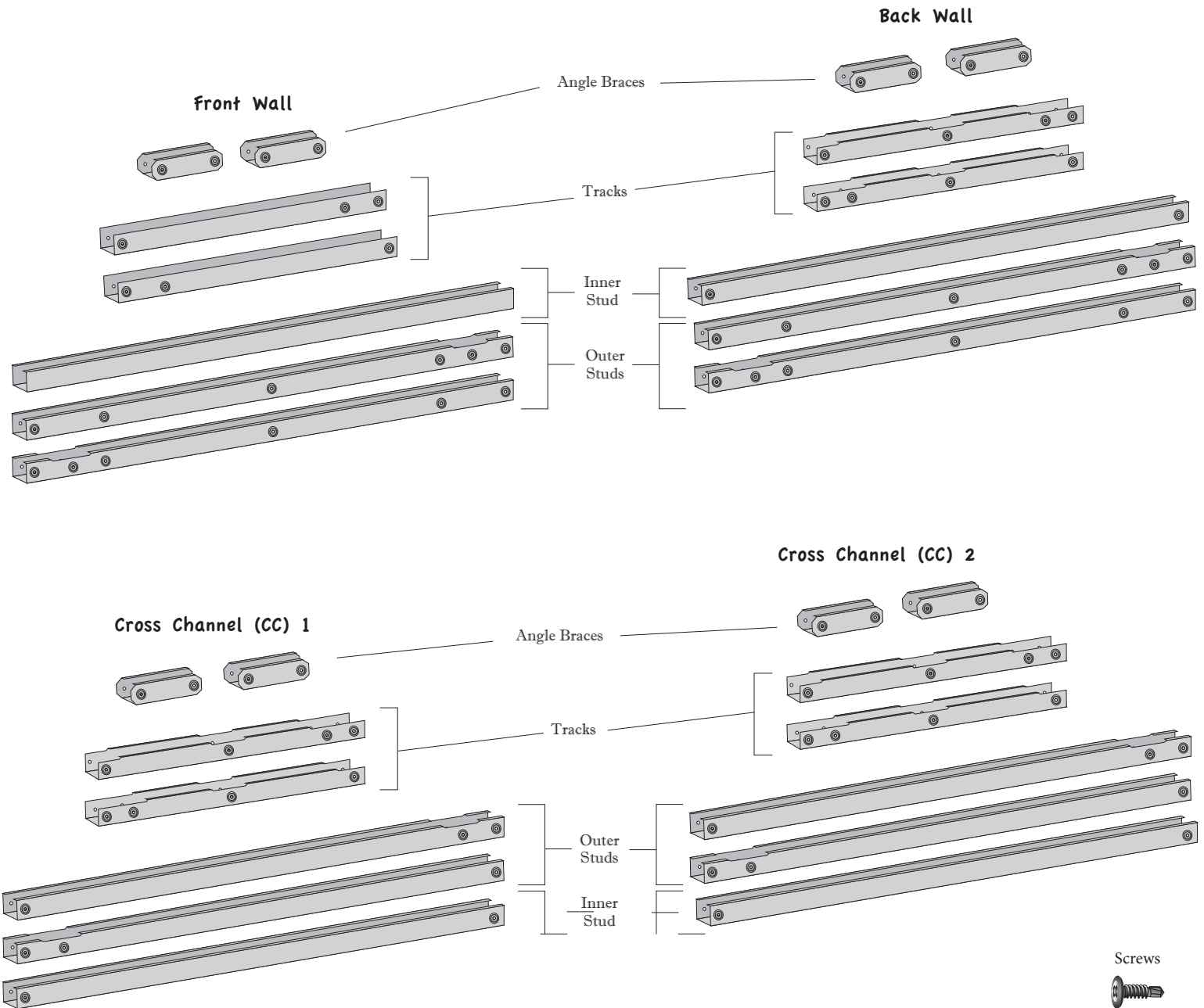

CHECK LIST

- ☐ 8 Angle Braces
- ☐ 8 Tracks (The tracks for the front wall do not include lips or slats for better maneuverability of studs and for easier cutout insertion.)
- ☐ 8 Outer Studs
- ☐ 4 Inner Studs (The inner studs for the front wall do not include any pre-drilled holes because they are adjustable, allowing for a universal fit of all cutouts.)
- ☐ 96 Self-Tapping Screws

STEP 1

Align the tracks so that the double dimpled holes are opposite one another.

Note: When aligned correctly, the text printed on each stud will read exactly the same.



STEP 2

Spread out the pieces to form a loose framework of the wall prior to attaching anything.

Note: Keep the inner studs off to the side. These will be placed later in accordance with the placement of your cutout module(s).



STEP 3

Place one end of the first angle brace into the bottom track.

Note: You may place the angle brace into either the stud or the track first, however, it's easier to maneuver the brace into the opposite piece if you first slide your angle brace into the smaller of the two pieces.

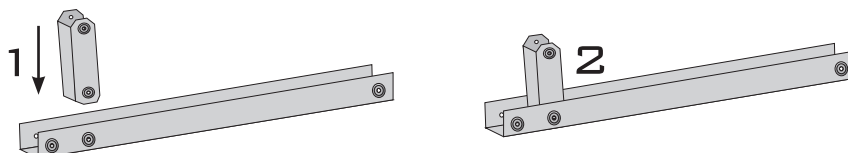

PROFESSIONAL TIP - PLACING THE ANGLE BRACE

Avoid pinching your fingers in between the angle brace and the stud or track by holding the angle brace at the top most half (as opposed to the bottom most half).

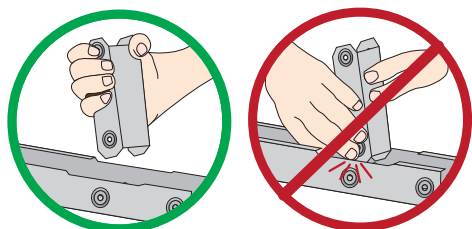

Place the angle brace with the inside facing the center of the stud or track. When placed the opposite way, a gap will form and the angle brace will no longer be flush.

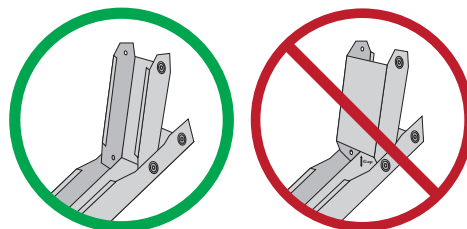

STEP 4

Slide the other side of the angle brace into the corresponding outer left stud and then easily swing the track into place on the edge of the stud. Reconfigure the pieces so that the track rests at the bottom.

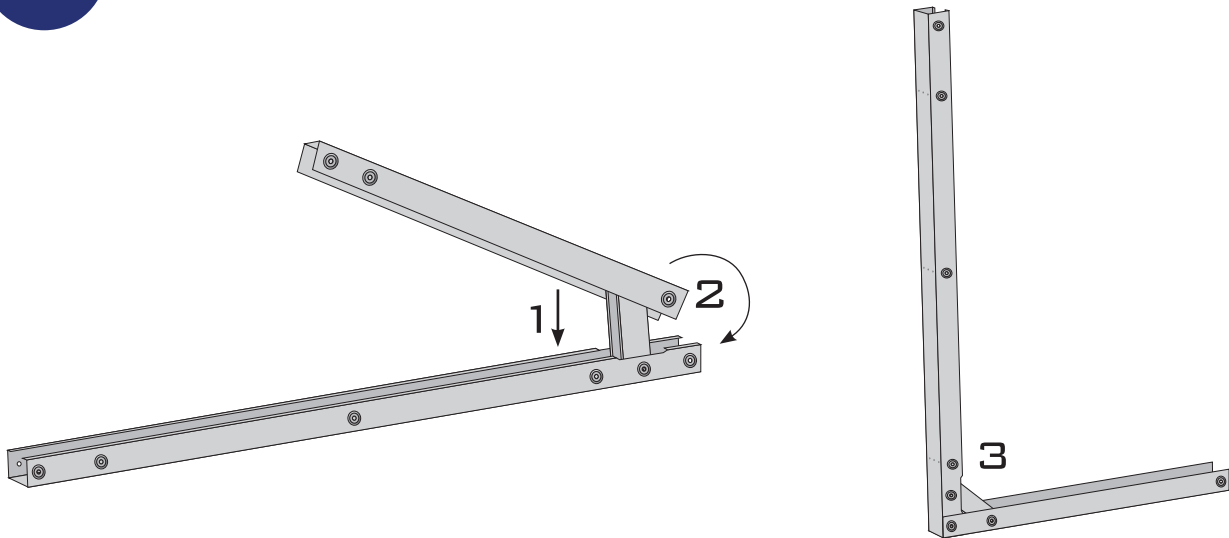

STEP 5

Repeat steps 3 and 4 to attach the second angle brace to the opposite stud and track. You should now have two L-shaped pieces. Slide the unattached ends together and make sure that all corners are flush.

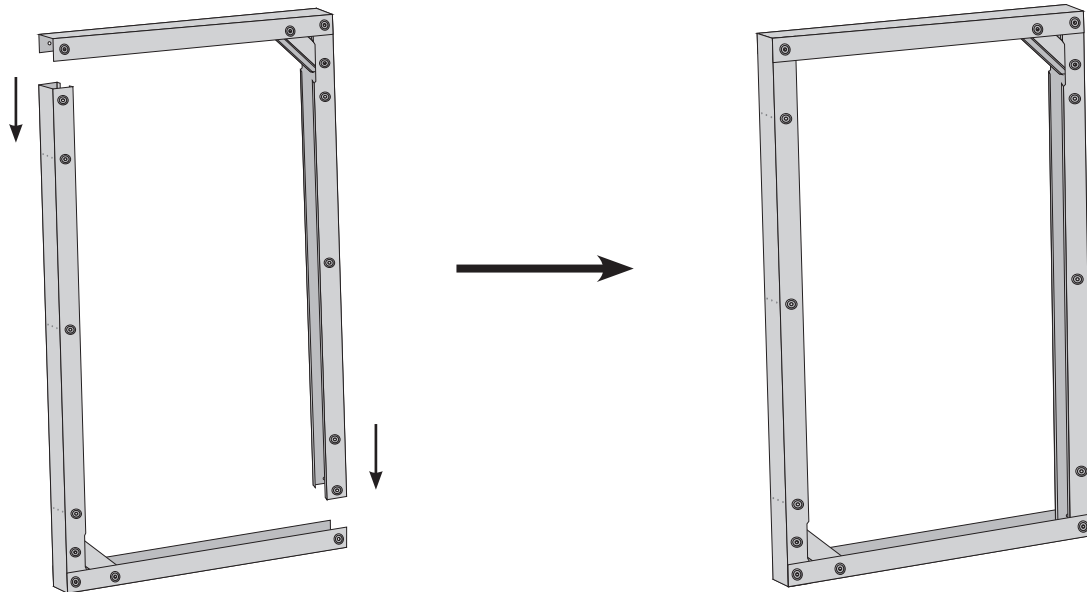

PROFESSIONAL TIP - FLUSH CORNERS

When placing two corners together, the pieces may not always appear completely flush. This is okay. The integrity of the module will not be affected.

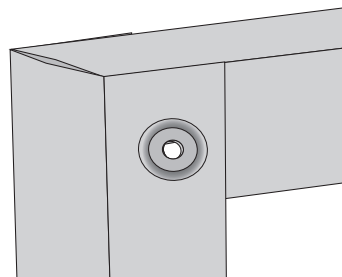

STEP 6

Drill six (6) screws into the pre-drilled holes across the top and bottom tracks, as well as two (2) screws into the outer studs where the angle braces rest (for a total of eight (8) screws).

Note: Begin with the Corner (see Inset), then finish screwing the angle brace before moving counterclockwise around the frame.

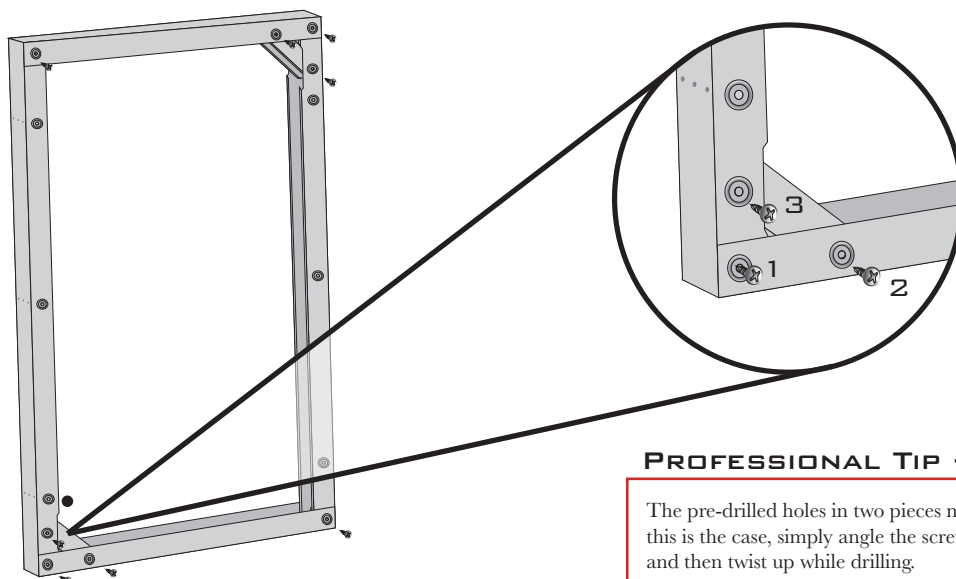

PROFESSIONAL TIP - UNEVEN HOLES

The pre-drilled holes in two pieces may not always align perfectly. If this is the case, simply angle the screw into the opening of both holes and then twist up while drilling.

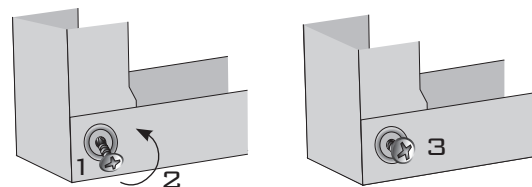

STEP 7

Flip the frame over and repeat step 6 on the opposite side. You should now have a completed frame wall with a set of separate studs that will be added and adjusted once the entire module has been completed.

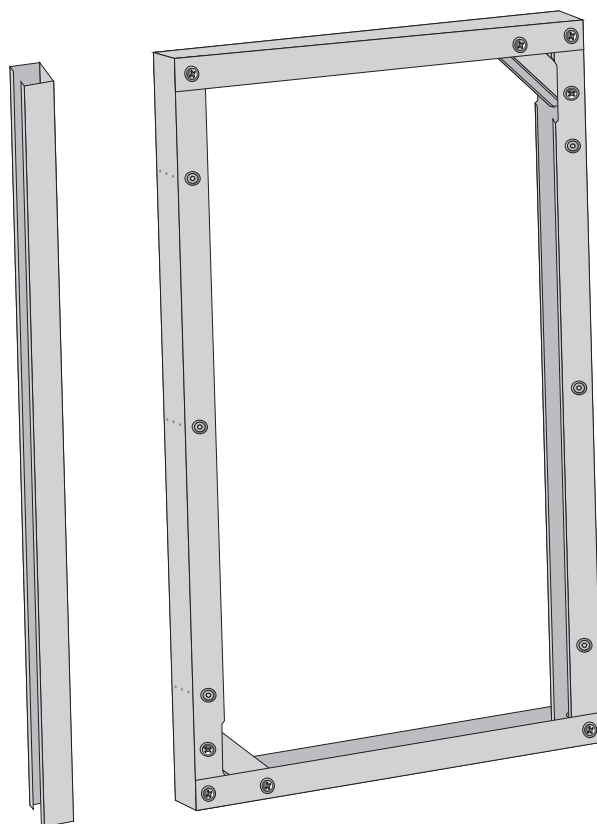

Back Wall Assembly

STEP 1

Align the tracks so that the double dimpled holes are opposite one another.

Note: When aligned correctly, the text printed on each stud will read exactly the same.

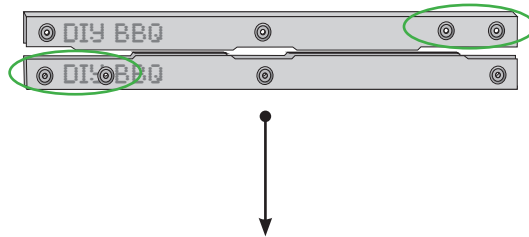

PROFESSIONAL TIP - ALIGNING CUTS

When aligning the tracks for the back of the module, if any of the cuts of each track are misaligned, one of the tracks needs to be flipped so that all cuts of both tracks line up.

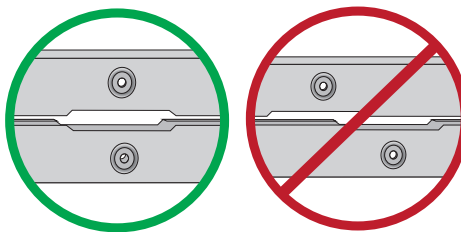

STEP 2

Spread out the pieces to form a loose framework of the wall prior to attaching anything.

Note: Unlike the front wall, the center studs will be positioned within the frame and remain fixed in place.

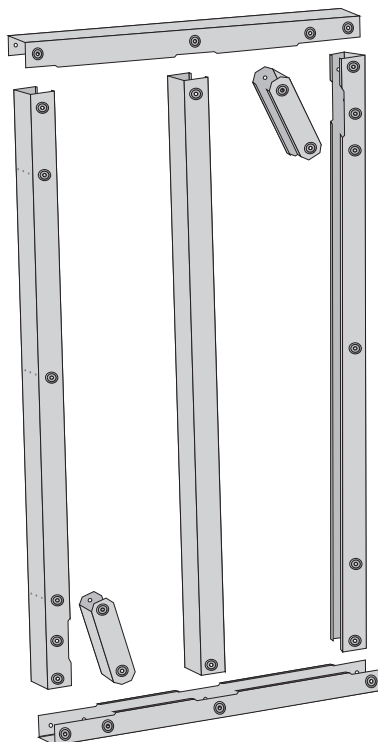

STEP 3

Place one end of the first angle brace into the bottom track.
Note: You may place the angle brace into either the stud or the track first, however, it's easier to maneuver the brace into the opposite piece if you first slide your angle brace into the smaller of the two pieces.

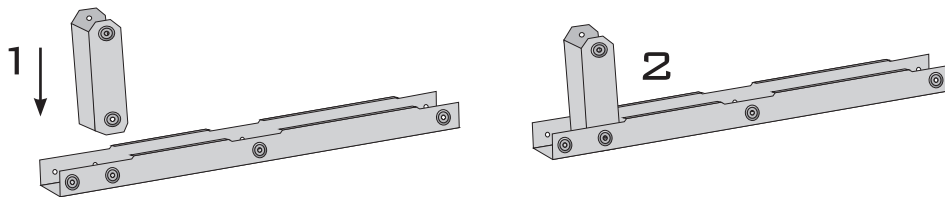

STEP 4

Slide the other side of the angle brace into the outer left stud and then easily swing the track into place on the edge of the stud. Reconfigure the pieces so that the track rests at the bottom.

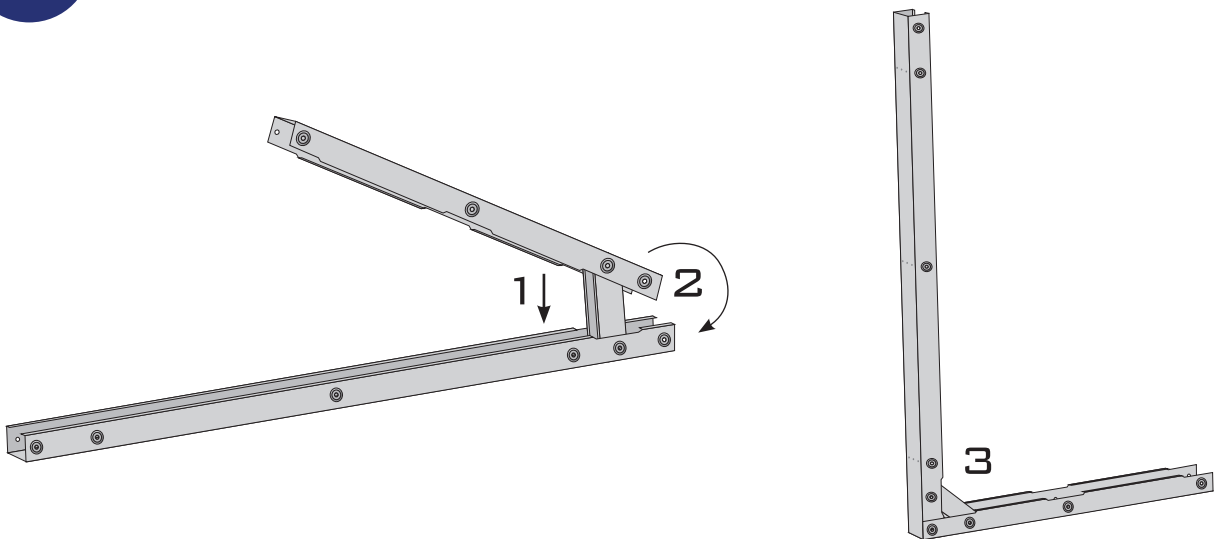

STEP 5

Repeat steps 3 and 4 to attach the second angle brace to the opposite stud and track. You should now have two L-shaped pieces.

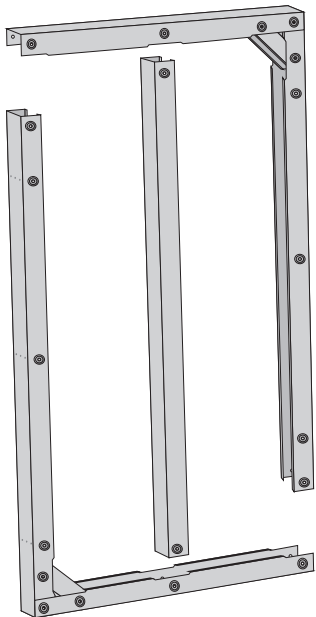

STEP 6

Slide each center stud into the bottom track. Make sure that each of the precut holes line up.

Note: Each stud has a number reference, where Stud 1 will sit on the right with each number running consecutively to the left. This isn't necessary, but keeps everything organized.

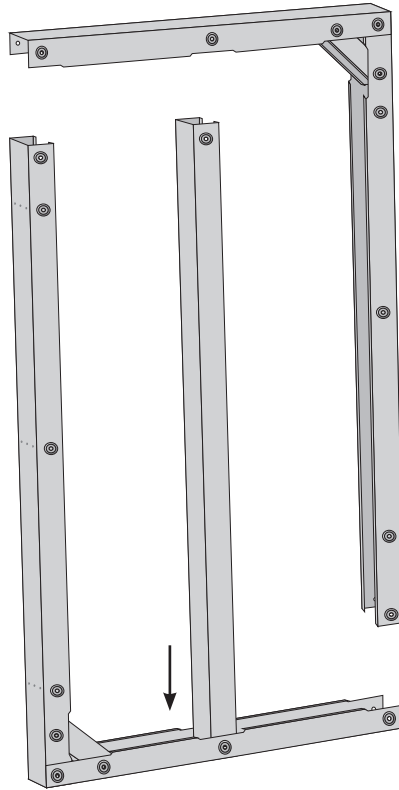

STEP 7

Slide the second L-Shape piece into the end of the bottom track.

Note: When sliding the stud into the track, the top track may bend up slightly. Do not worry. This will be adjusted in the next step.

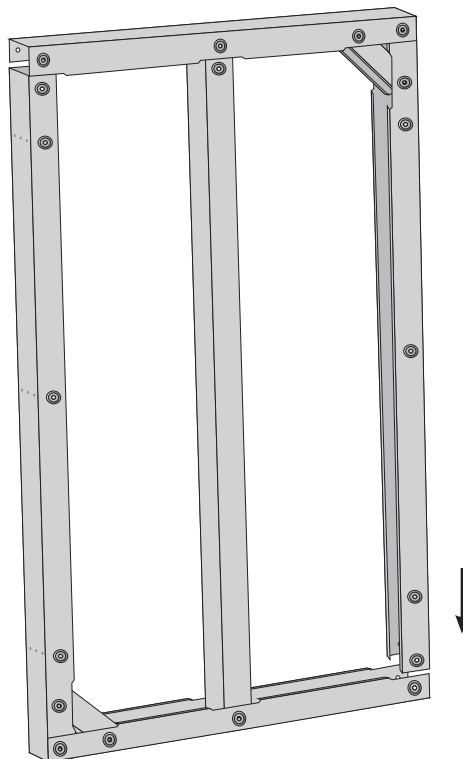

STEP 8

Adjust the top of each stud so that they fit comfortably inside the top track. Then use the butt of your palm to carefully but firmly hit each stud into the top track so that all pre-cut holes in both the track and studs are aligned.

Note: If the studs do not slip right in when hit, readjust the studs and then reapply pressure to the track.

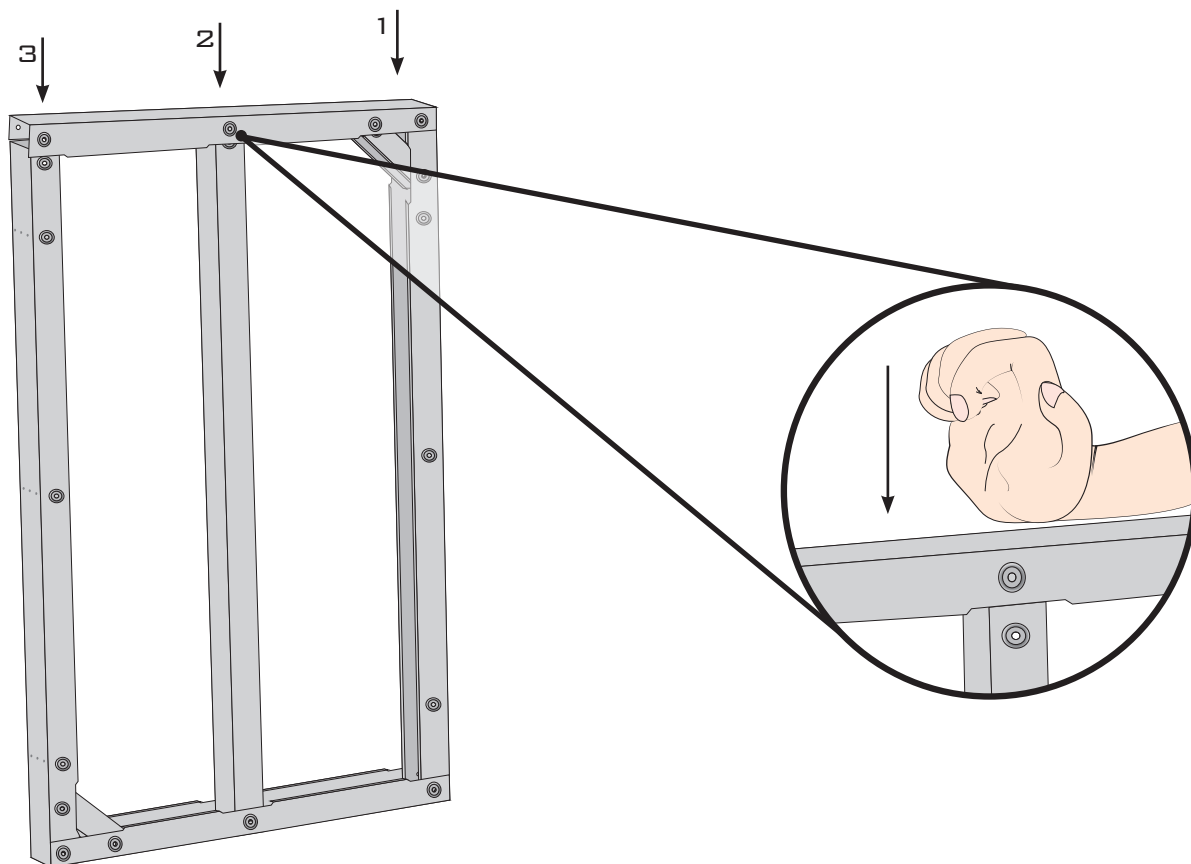

STEP 9

Drill eight (8) screws into the pre-drilled holes across the top and bottom tracks, as well as two (2) screws into the outer studs where the angle braces rest (for a total of ten (10) screws). When complete, flip the wall over and drill ten (10) additional screws into the opposite side. You should now have a completed frame wall.

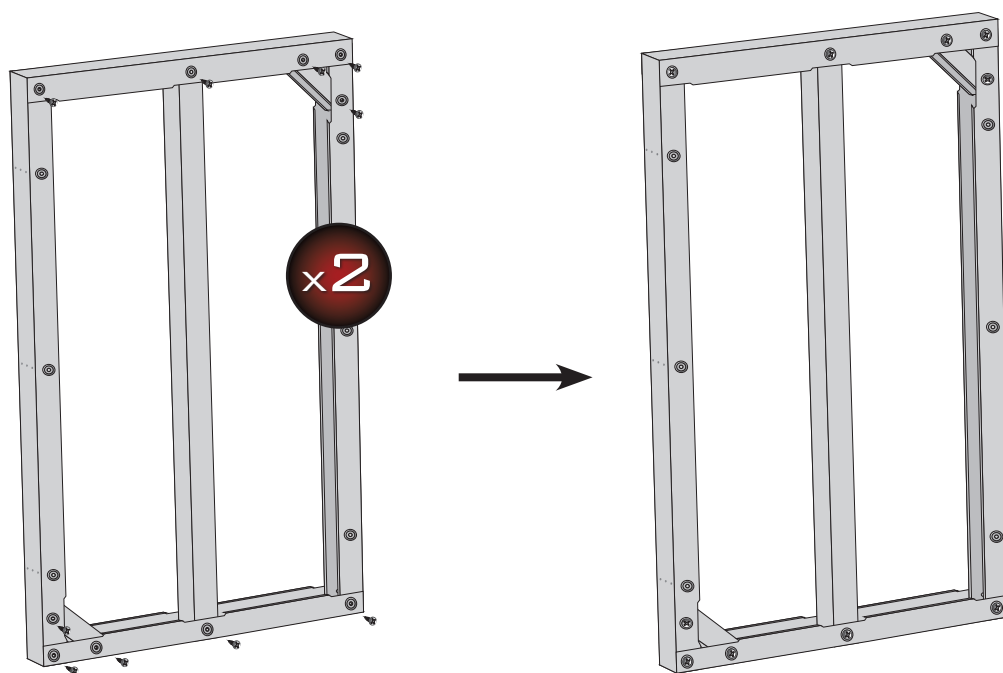

Cross Channel (CC) Wall Assembly

STEP 1

Align the tracks so that the double dimpled holes are opposite one another.

Note: When aligned correctly, the text printed on each stud will read exactly the same.

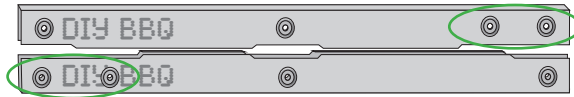

STEP 2

Spread out the pieces to form a loose framework of the wall prior to attaching anything.

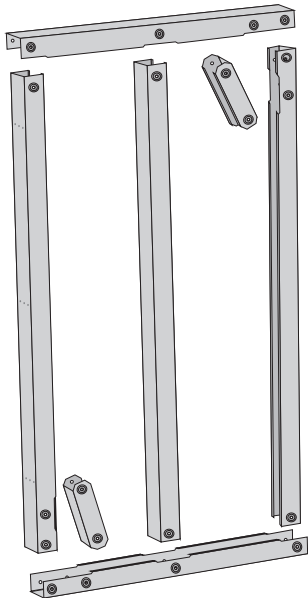

STEP 3

Place one end of the first angle brace into the bottom track.

Note: You may place the angle brace into either the stud or the track first, however, it's easier to maneuver the brace into the opposite piece if you first slide your angle brace into the smaller of the two pieces.

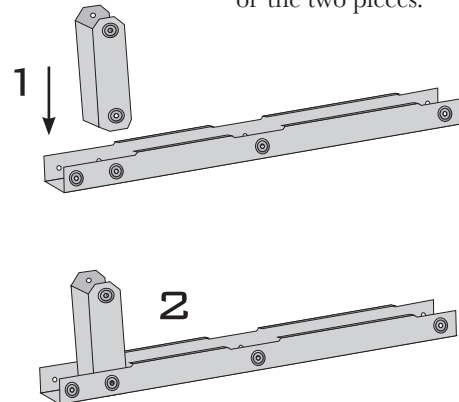

STEP 4

Slide the other side of the angle brace into the corresponding stud and then easily swing the track into place on the edge of the stud. Reconfigure the pieces so that the track rests at the bottom.

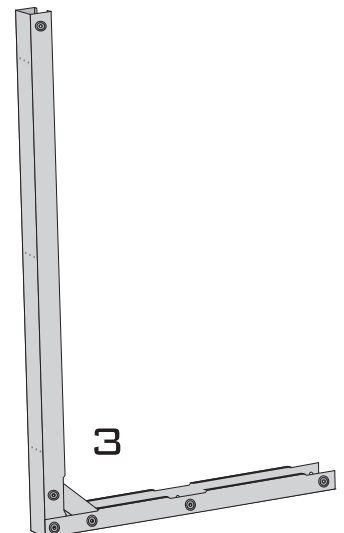
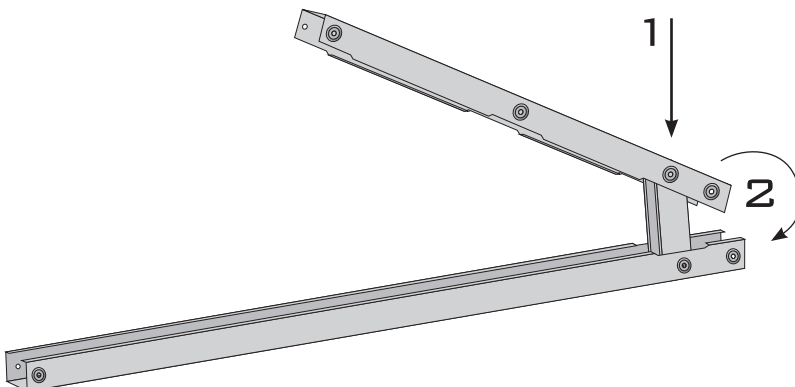

STEP 5

Repeat steps 3 and 4 to attach the second angle brace to the opposite stud and track. You should now have two L-shaped pieces.

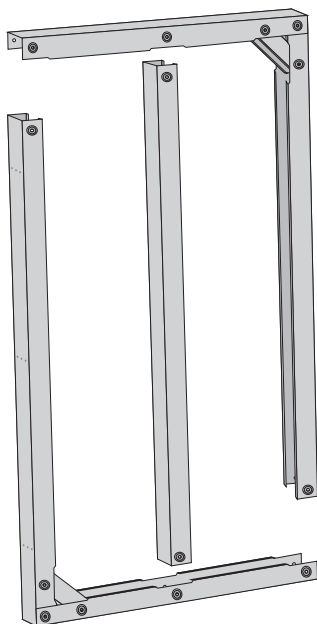

STEP 6

Slide the center stud into the bottom track. Make sure that the precut holes match up.

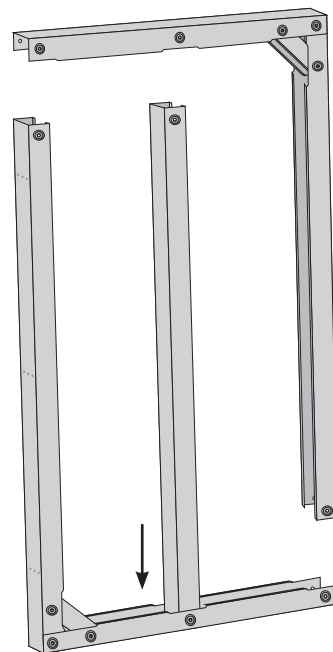

STEP 7

Slide the second L-Shape piece into the open end of the bottom track. **Note:** When sliding the stud into the track, the top track may bend up slightly. Do not worry. This will be adjusted in the next step.

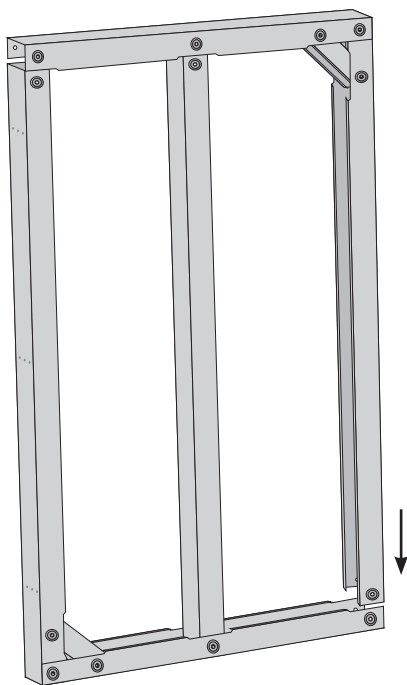

STEP 8

Adjust the top of each stud so that they fit comfortably inside the top track. Then use the butt of your palm to carefully, but firmly, hit each stud into the top track so that all precut holes in both the track and studs are aligned.

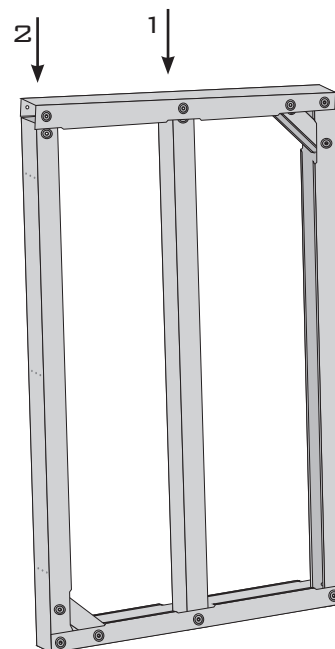

STEP 9

Drill screws in all ten (10) pre-drilled holes. When complete, flip the wall over and drill ten (10) additional screws into the opposite side. You should now have a completed frame wall.

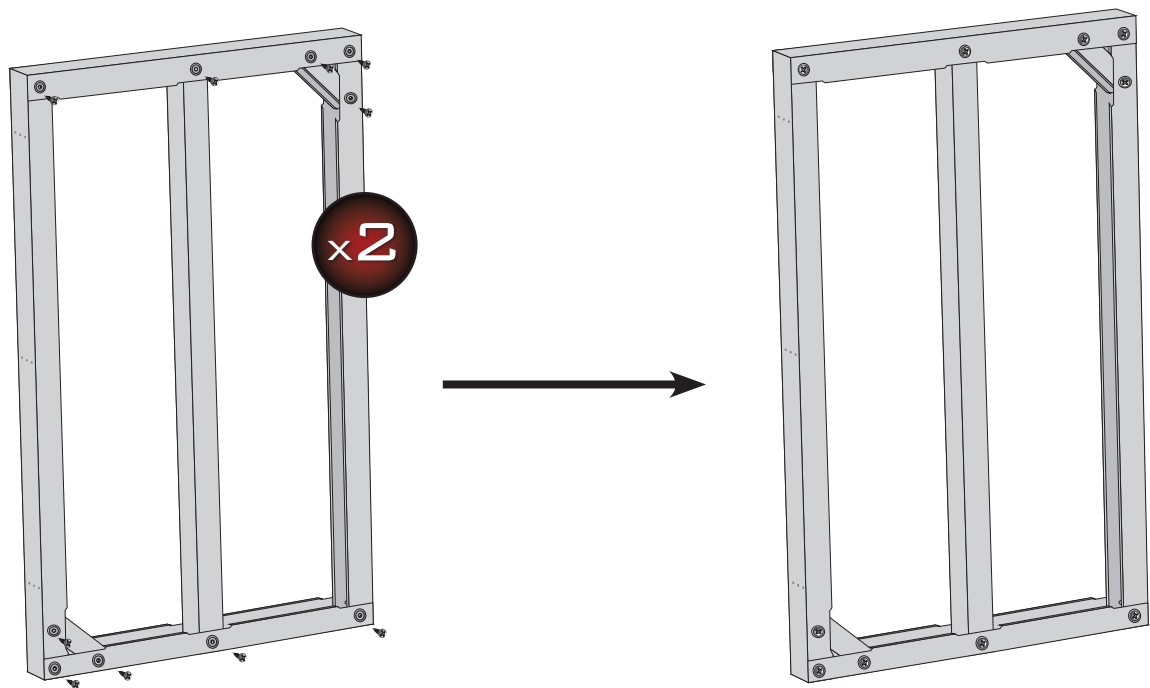

STEP 10

Repeat steps 1 through 9 for the second CC wall. You should now have two complete Cross Channel walls.

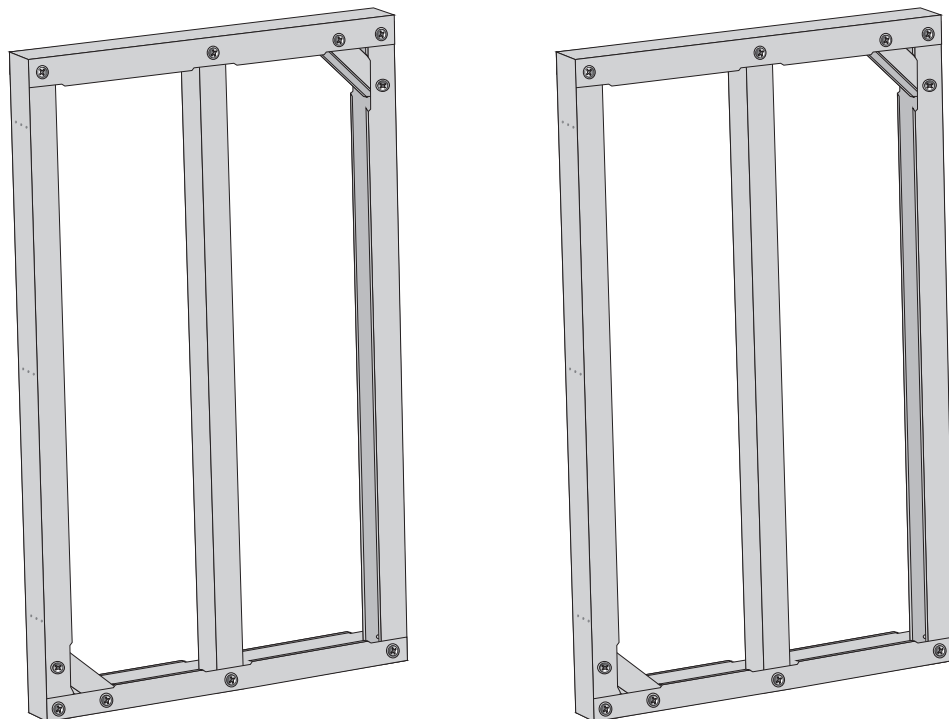

STEP 1

Make sure you have all of your assembled pieces.

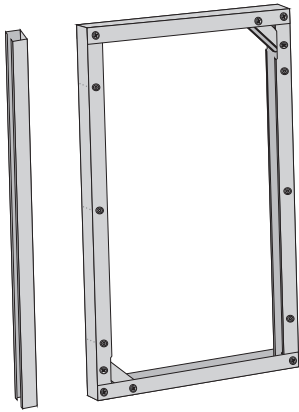

Front Perimeter Wall

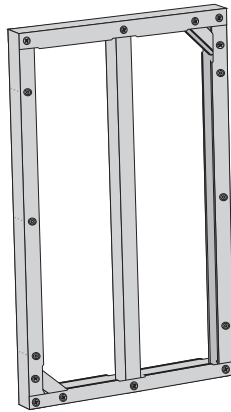

Back Perimeter Wall

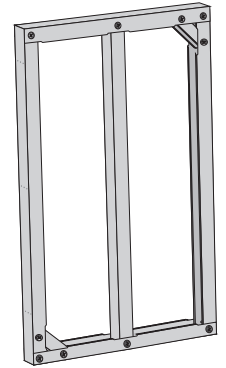
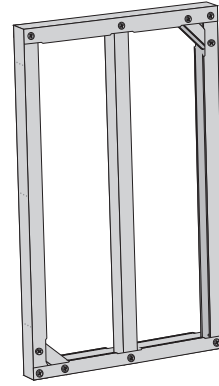

Cross Channel (CC) Walls

STEP 2

Slide the left Cross Channel (CC) wall so that it aligns perpendicular to the edge of the left side of the back Perimeter wall.

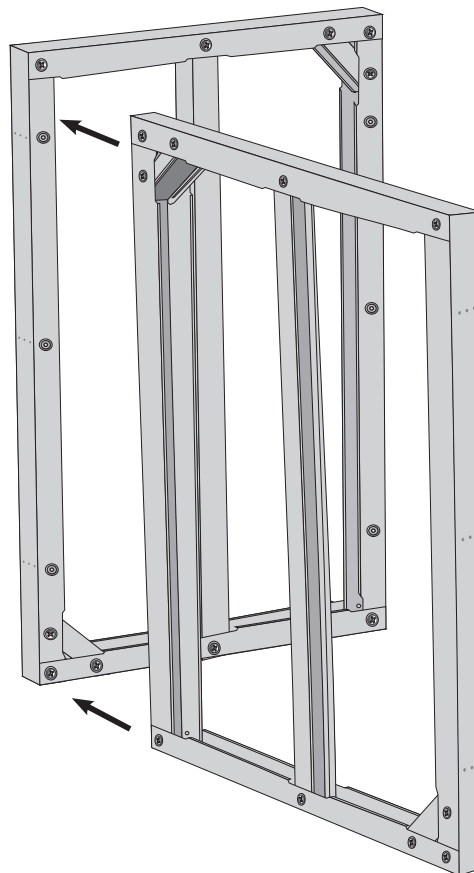

STEP 3

Attach the CC wall to the back Perimeter wall by drilling at least five (5) screws through the pre-drilled web holes found on the inner side of the CC wall.

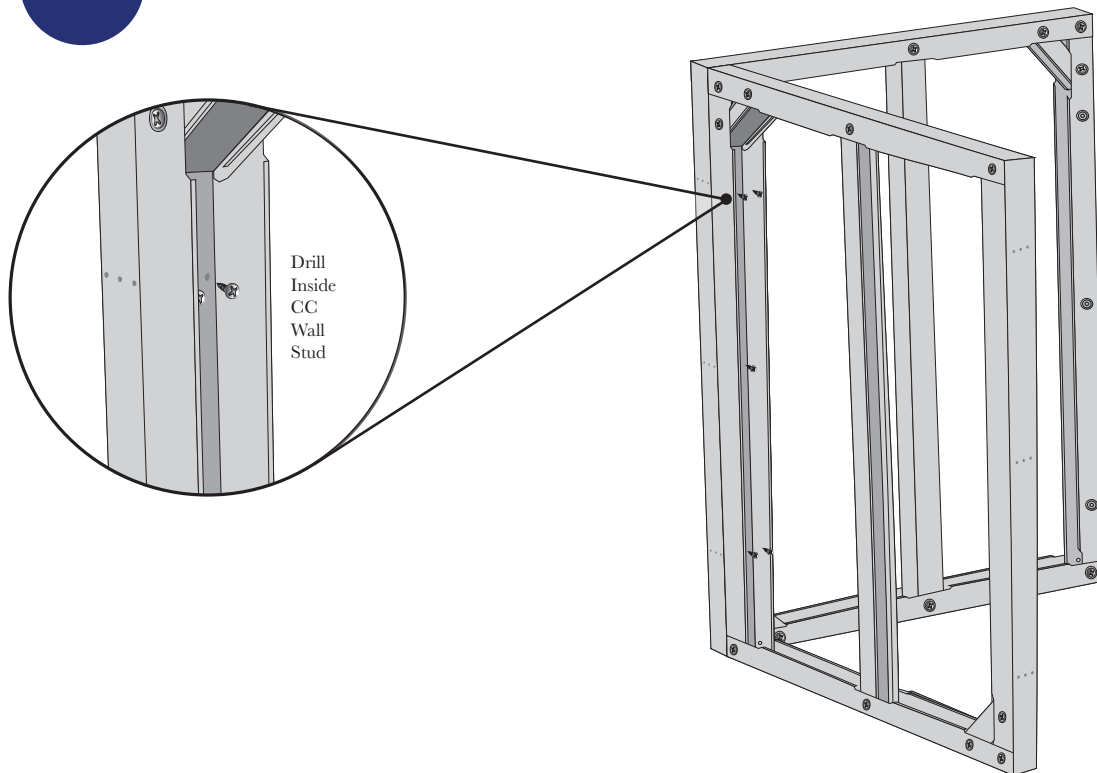

PROFESSIONAL TIP - ATTACHING CCs TO PERIMETER WALLS

Each outer stud of a Cross Channel wall includes a series of pre-cut web holes for easy drilling. For strongest integrity, use at least two screws in the top set, one in the center set and two in the bottom.

TOP SET

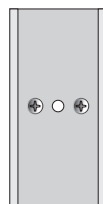

CENTER SET

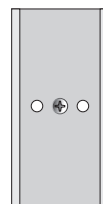

BOTTOM SET

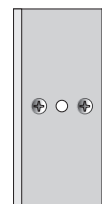

STEP 4

Repeat steps 2 and 3 to attach the second CC wall to the right back Perimeter wall.

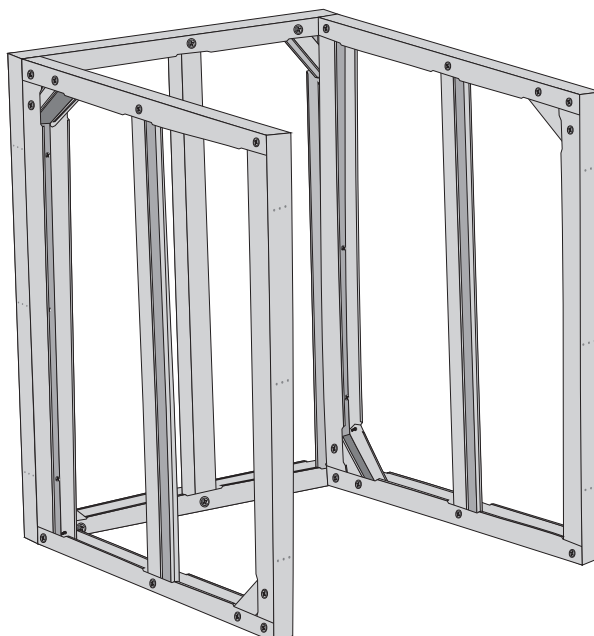

STEP 5

Place the front Perimeter wall in place and drill screws through the web holes (as seen in step 3) to attach the front wall to both CC walls.

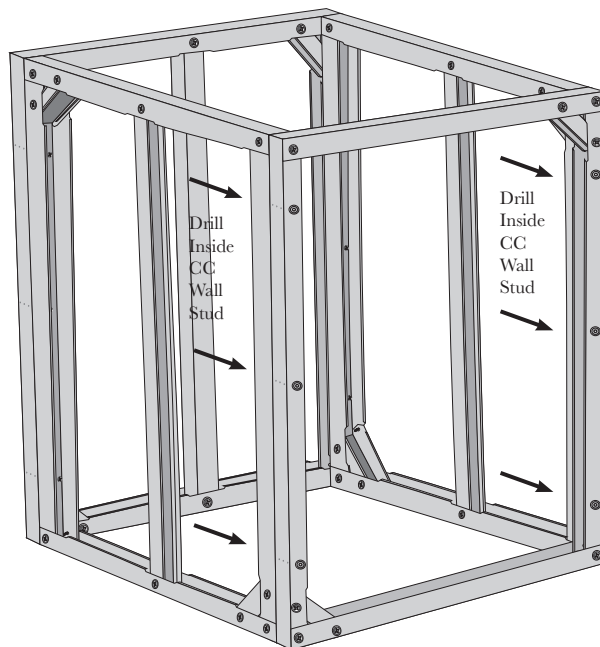

STEP 6

You should now have a complete module. If you're ready to add your cutout modules, measure the placement for each of the inside front wall studs and drill them into place. Otherwise, you may place the front wall studs into the front wall for safe keeping until you know the dimensions and placement of your cutouts.

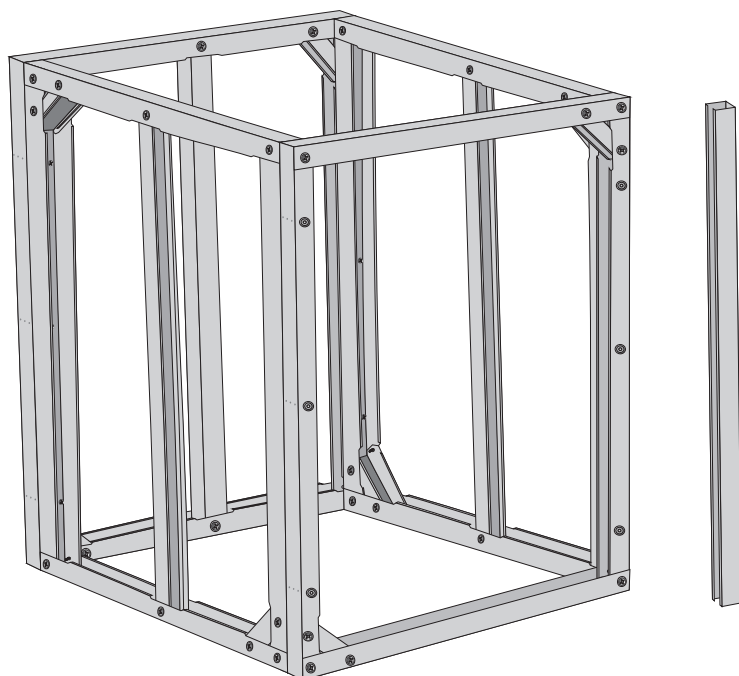

With Front Wall Studs Placed

